

АРГУС / ARGUS

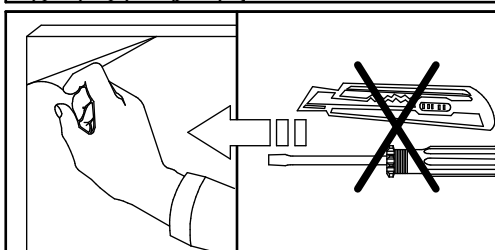

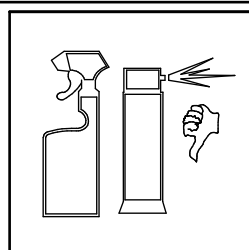

| | | | | | |
|---|--|--|---|--|--|
| 4x K16 a1 | 6x K0 a2 | 10x b1 | 6x L 340 mm c520 | 16x $\phi 5 \times 17$ mm d3 | 16x $\phi 7 \times 50$ mm e1 |
| 12x $\phi 6 \times 13$ mm e3 | 4x $\phi 5 \times 11$ mm e4 | 8x $\phi 5 \times 50$ mm e32 | 56x $\phi 8 \times 35$ mm f29 | 2x g2 | 10x 56x56/20 mm k52 |
| 120x i1 | 16x i2 | 16x 3 mm i3 | 2x m48 | 2x n2 | 2x 50x12/1,5 mm n3 |
| 4x n10 | 12x 20x13x3,5/1 mm n108 | 4x n122\1 | 4x silikon $\phi 8 \times 1,8$ mm o21 | 4x o43/1 | 8x $\phi 3,5 \times 13$ mm p1 |
| 1x o43/6 | 4x $\phi 3,5 \times 13$ mm p5 | 18x $\phi 4 \times 30$ mm p9 | 28x $\phi 4 \times 30$ mm p21 | 16x $\phi 3 \times 16$ mm p52 | |
| 8x $\phi 3 \times 12$ mm p54 | 12x $\phi 2,9 \times 16$ mm p55 | 4x $\phi 3 \times 10$ mm p400 | 68x $\phi 15 \times 12$ mm #16 r1 | 68x 30/11 r23 | 60x $\phi 16$ s2 |
| 4x $\phi 5$ s4 | 2x 350 mm w45^{CL} | 2x 350 mm w45^{CR} | 2x 350 mm w45^{DL} | 2x 350 mm w45^{DR} | 1x z1 |

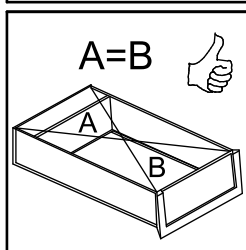
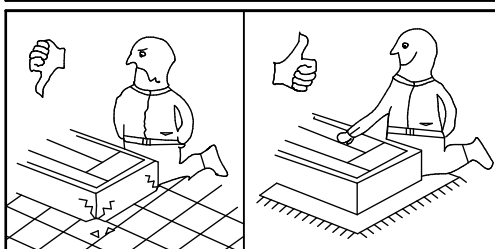
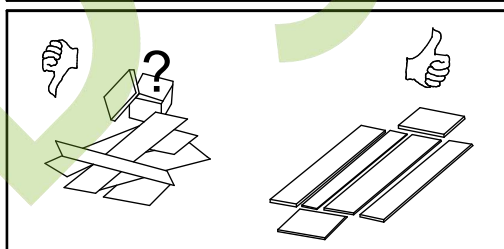
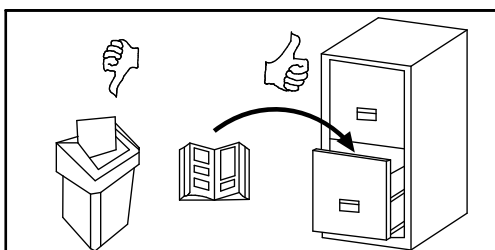
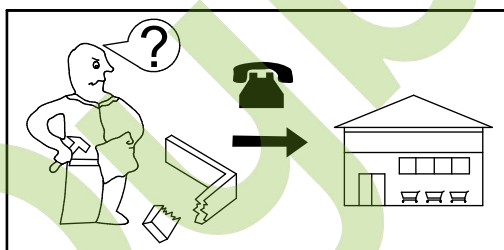
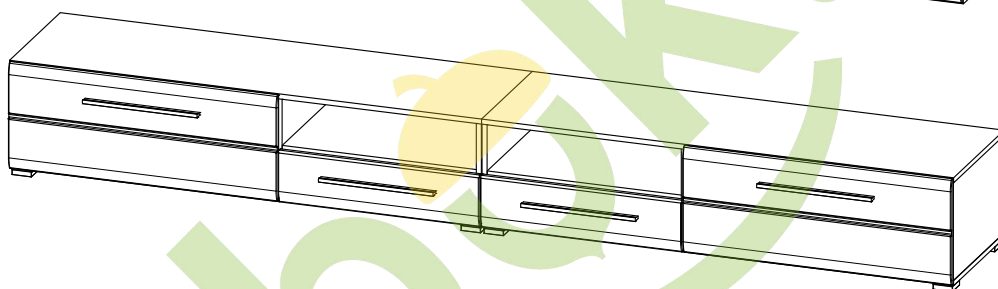
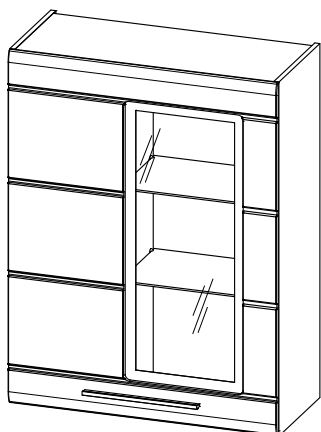
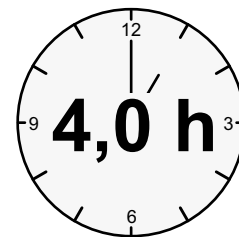
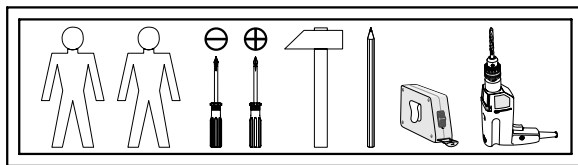
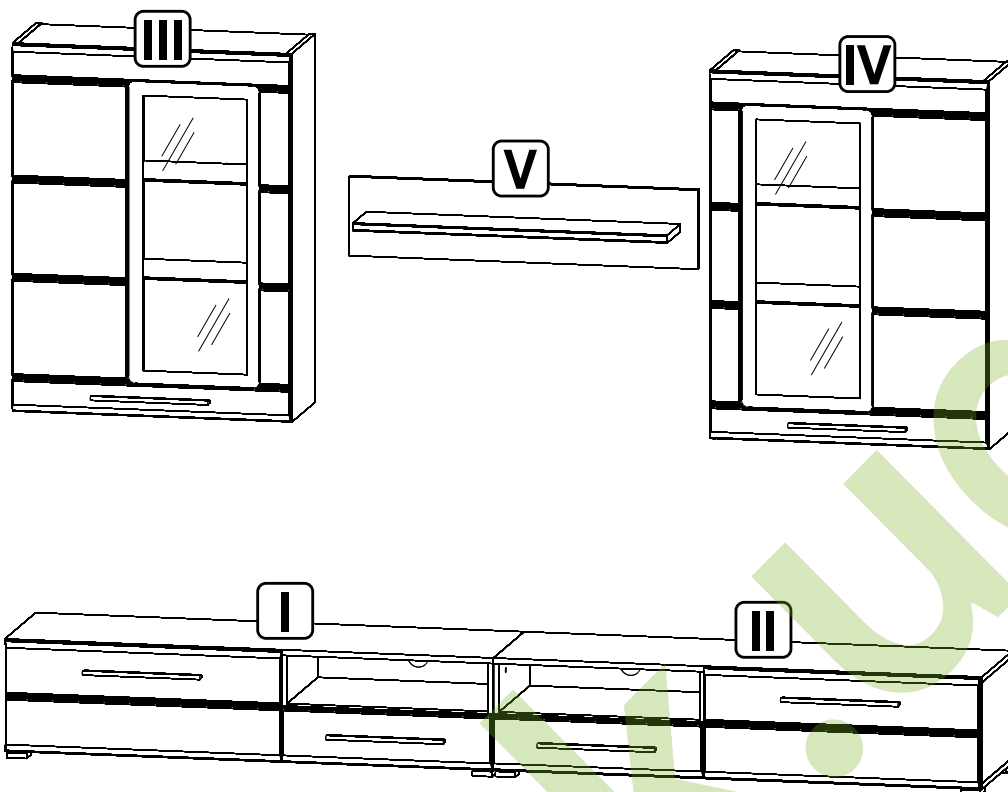
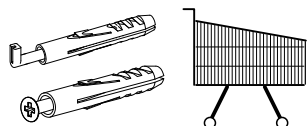



Тумба РТВ ліва / Тумба РТВ левая / Szafka RTV lewa

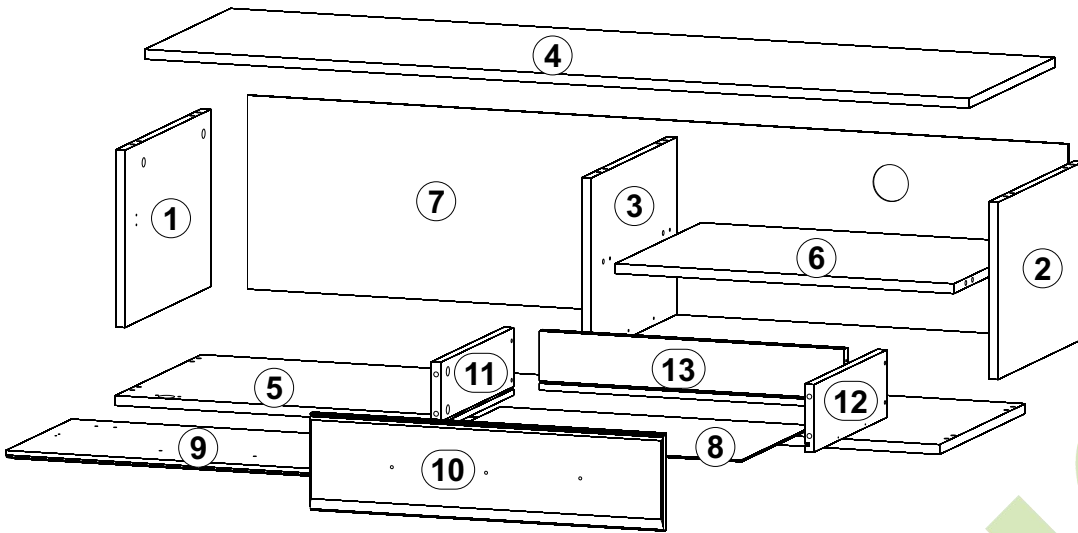

| A | B | C | D | | A | B | C | D | |
|---|---------|------|-----|-----|----|----------|-----|-----|-----|
| 1 | PU1-101 | 288 | 413 | 1/5 | 8 | PU1-918 | 533 | 349 | 1/5 |
| 2 | PU1-118 | 288 | 413 | 1/5 | 9 | PU1-017A | 792 | 316 | 5/5 |
| 3 | PU1-117 | 288 | 413 | 1/5 | 10 | PU1-018A | 600 | 158 | 5/5 |
| 4 | PU1-201 | 1400 | 413 | 1/5 | 11 | PU1-555 | 350 | 110 | 5/5 |
| 5 | PU1-220 | 1400 | 413 | 1/5 | 12 | PU1-556 | 350 | 110 | 5/5 |
| 6 | PU1-301 | 575 | 413 | 1/5 | 13 | PU1-557 | 518 | 110 | 3/5 |
| 7 | PU1-901 | 1394 | 315 | 1/5 | | | | | |

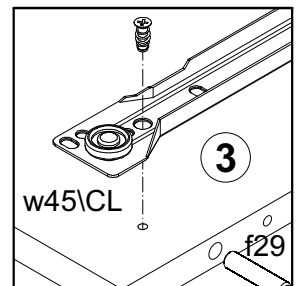
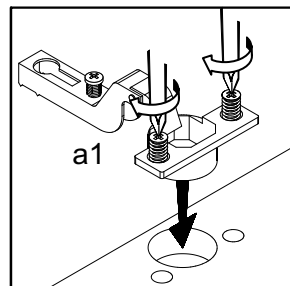
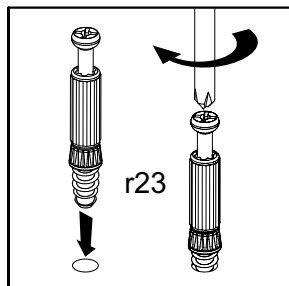
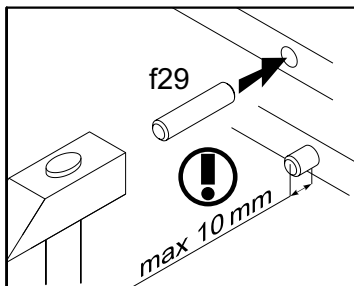
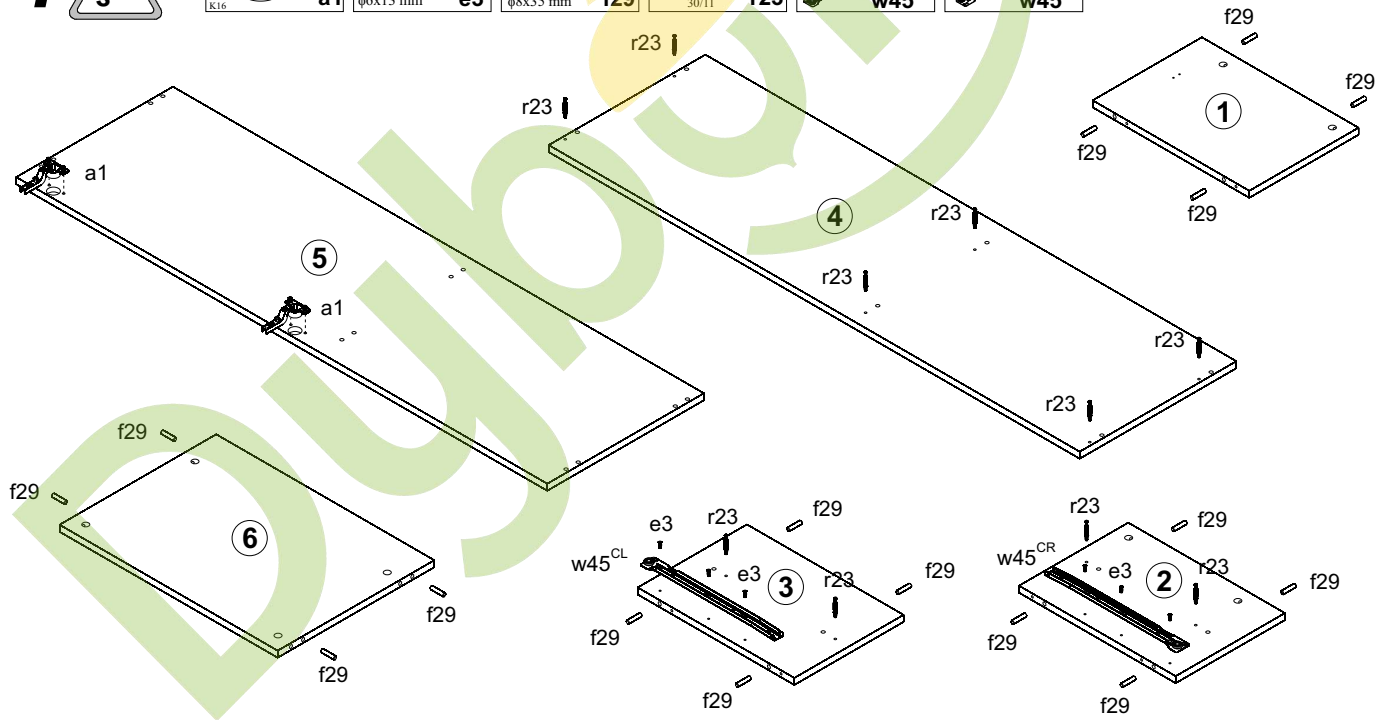
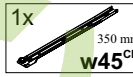
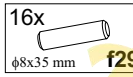
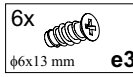
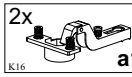

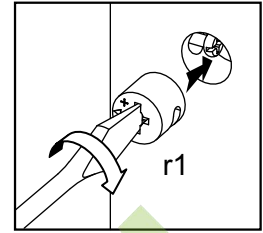
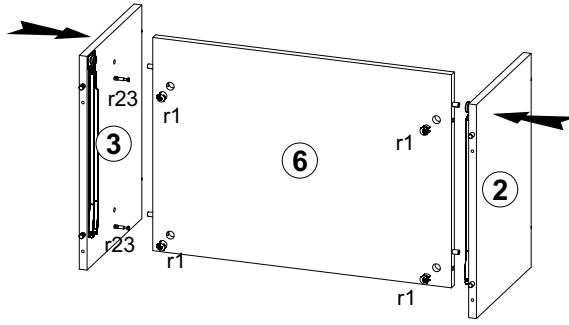
24x $\phi 15 \times 12 \text{ mm}$ #16 r1**3**6x $\phi 7 \times 50 \text{ mm}$ e16x $\phi 15 \times 12 \text{ mm}$ #16 r1

1x z1

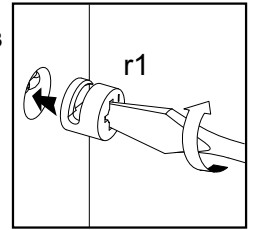
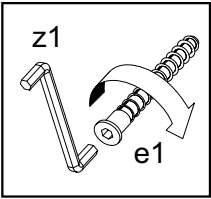
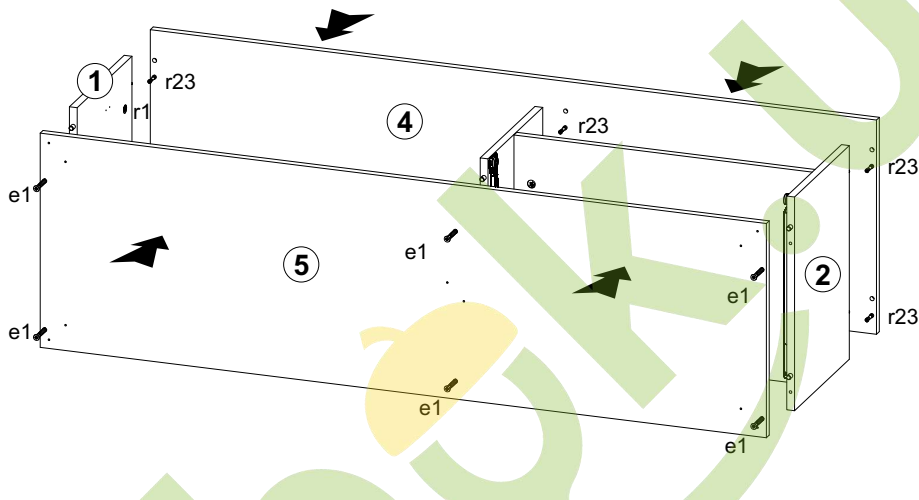
**4**

36x l1

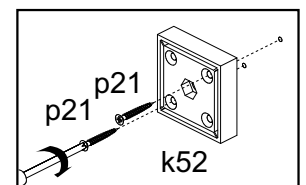
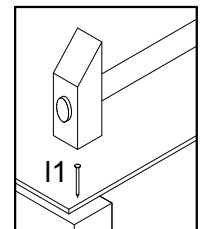
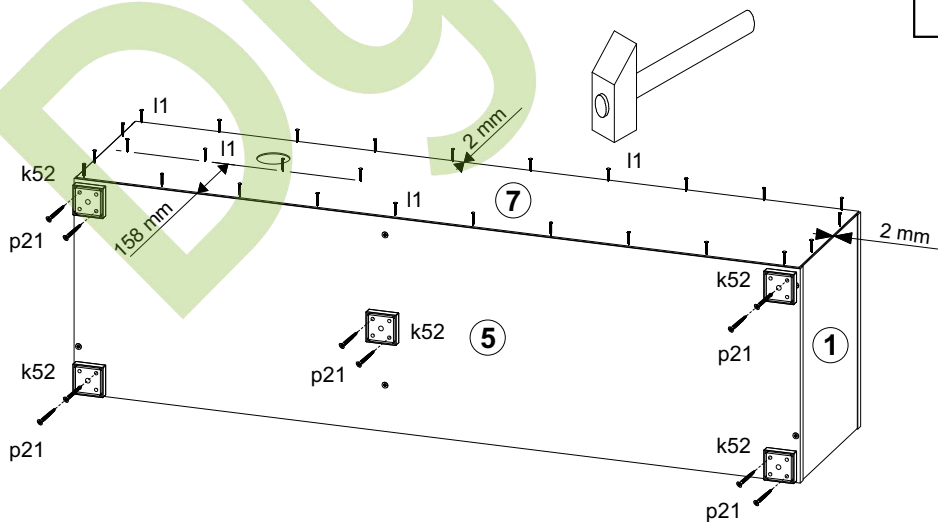
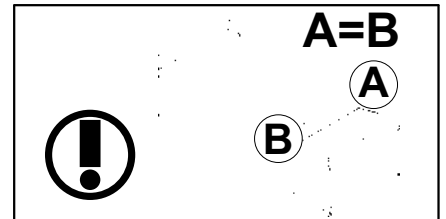
5x k52 $56 \times 56 \times 20 \text{ mm}$ 10x $\phi 4 \times 30 \text{ mm}$ p21

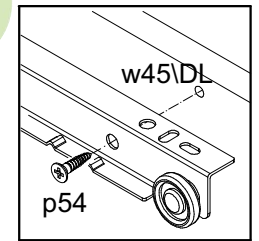
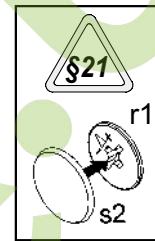
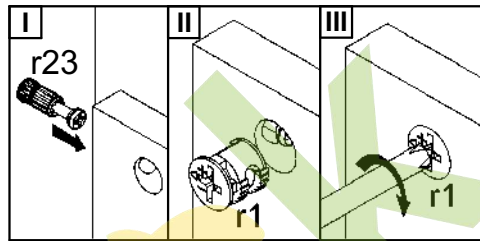
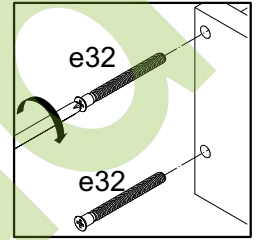
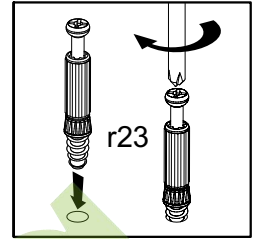
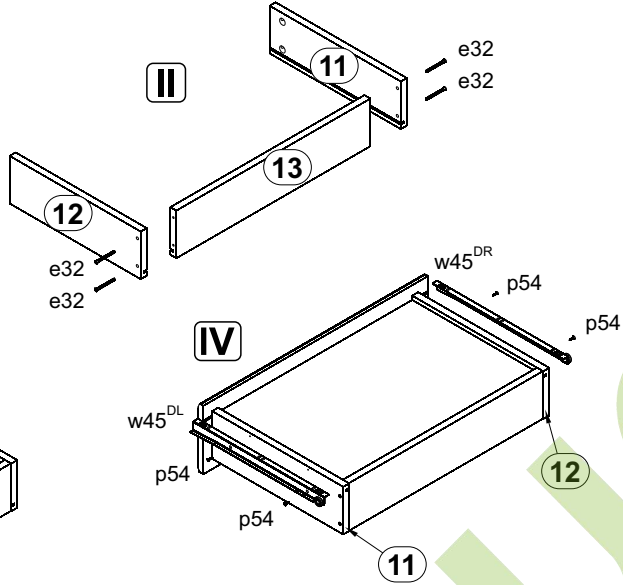
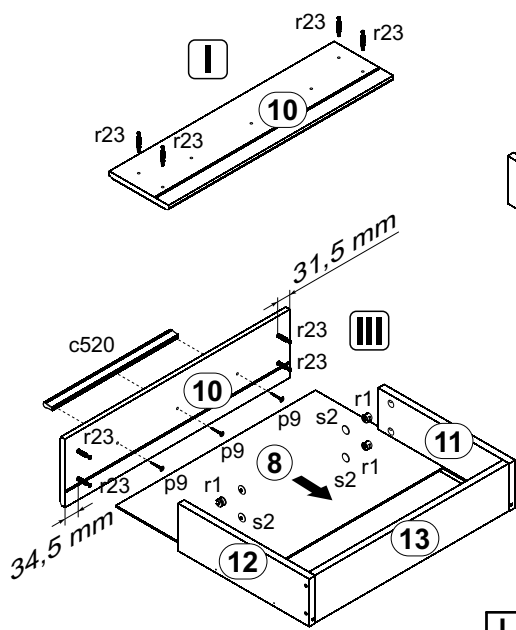
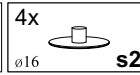
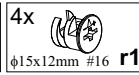
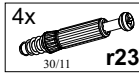
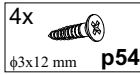
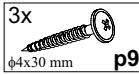
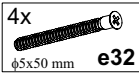
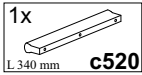
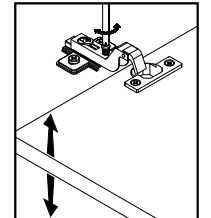
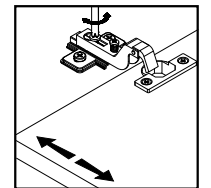
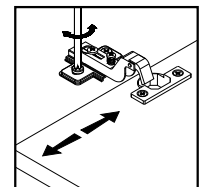
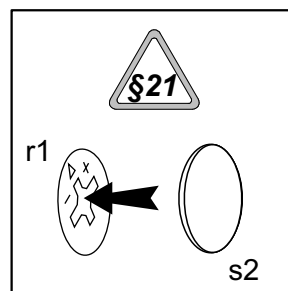
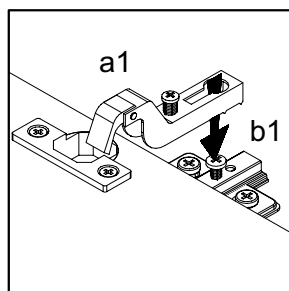
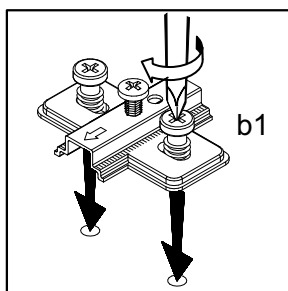
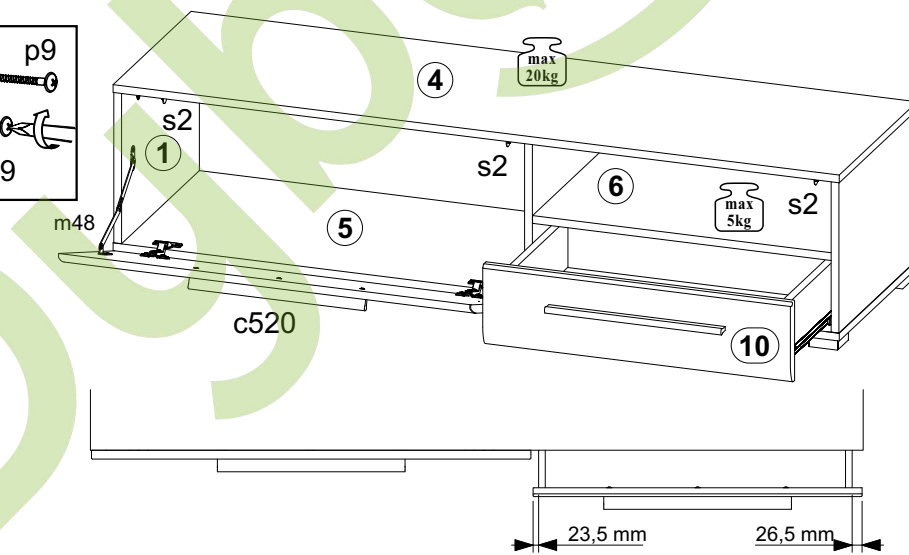
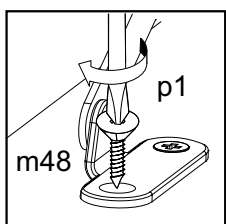
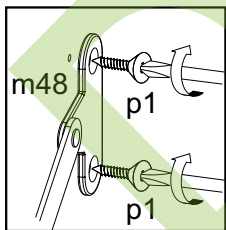
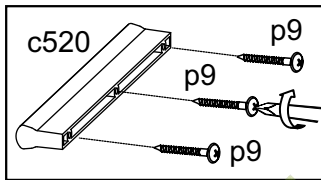
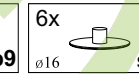
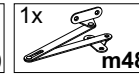
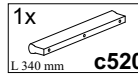
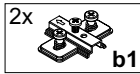
5**6**



Тумба РТВ права / Тумба РТВ правая / Szafka RTV prawa

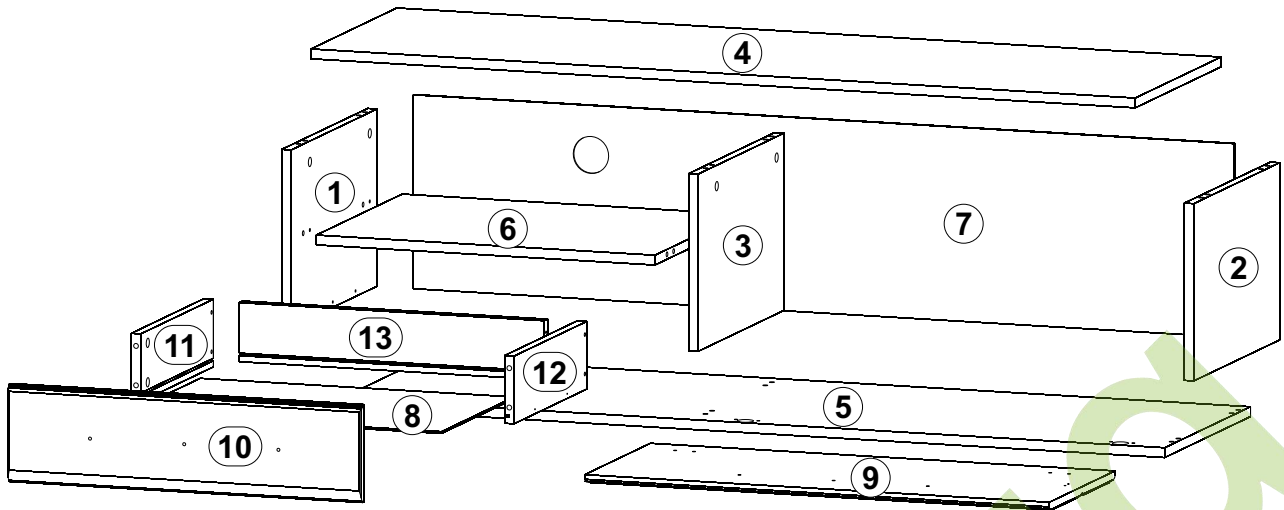

| A | B | C | D | A | B | C | D | | |
|---|---------|------|-----|-----|----|----------|-----|-----|-----|
| 1 | PU1-119 | 288 | 413 | 2/5 | 8 | PU1-904 | 554 | 378 | 2/5 |
| 2 | PU1-106 | 288 | 413 | 2/5 | 9 | PU1-020A | 792 | 316 | 5/5 |
| 3 | PU1-120 | 288 | 413 | 2/5 | 10 | PU1-119A | 600 | 158 | 5/5 |
| 4 | PU1-203 | 1400 | 413 | 2/5 | 11 | PU1-555 | 350 | 110 | 5/5 |
| 5 | PU1-221 | 1400 | 413 | 2/5 | 12 | PU1-556 | 350 | 110 | 5/5 |
| 6 | PU1-301 | 575 | 413 | 2/5 | 13 | PU1-518 | 543 | 110 | 3/5 |
| 7 | PU1-907 | 1394 | 315 | 2/5 | | | | | |



7

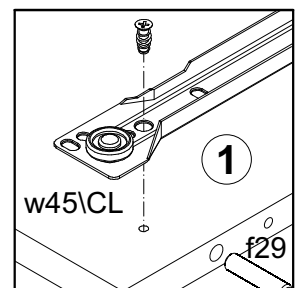
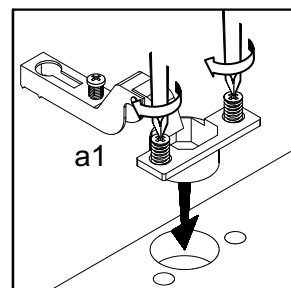
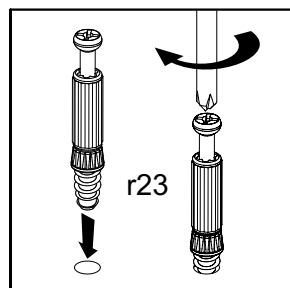
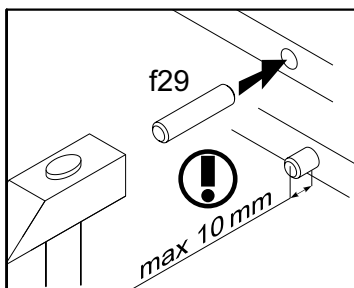
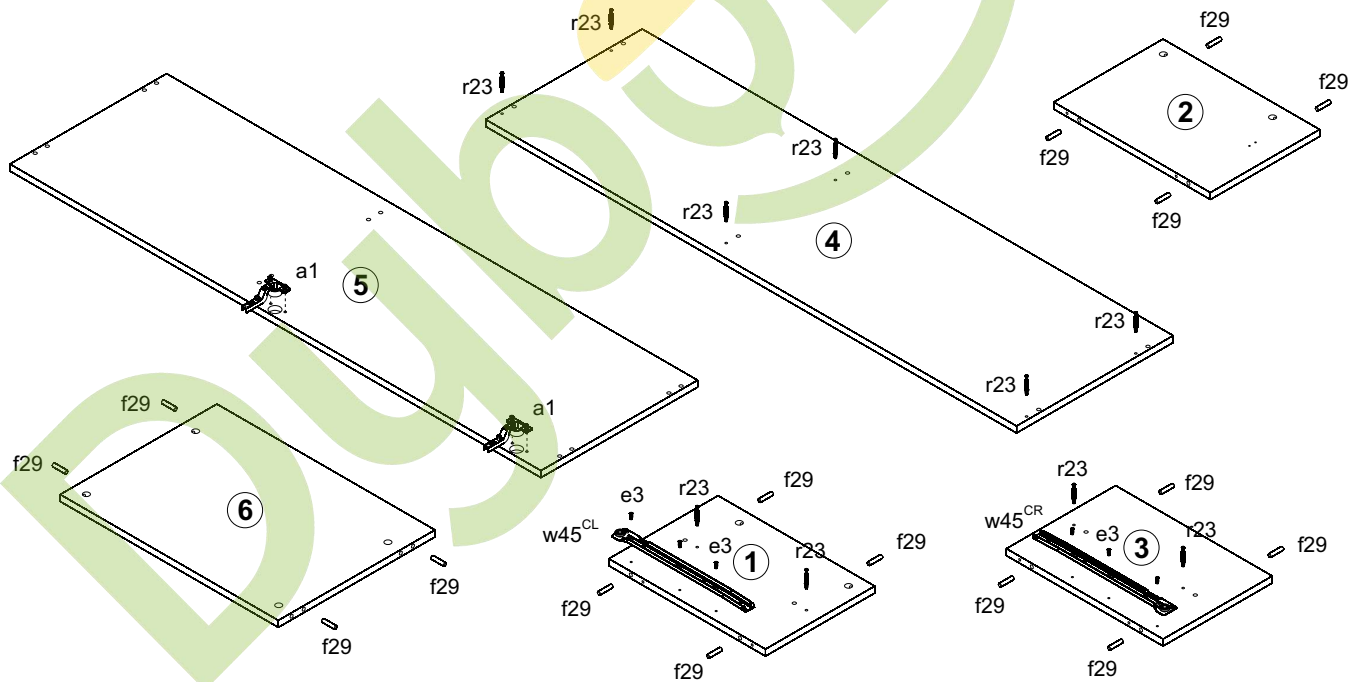
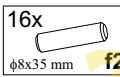
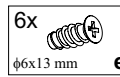
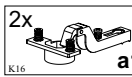

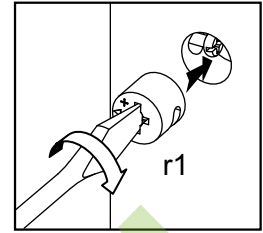
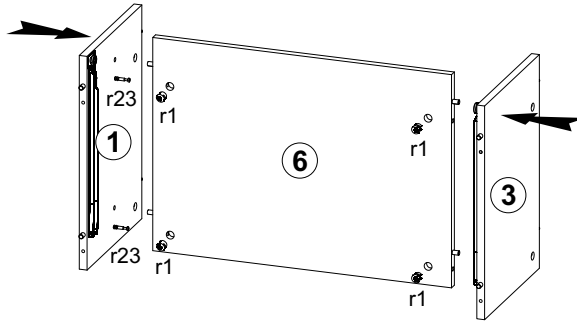

8

4x  $\phi 15 \times 12 \text{ mm}$ #16 r1

**9**

6x  $\phi 7 \times 50 \text{ mm}$ e1

6x  $\phi 15 \times 12 \text{ mm}$ #16 r1

1x  z1

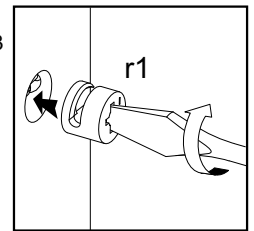
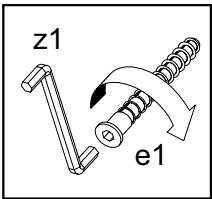
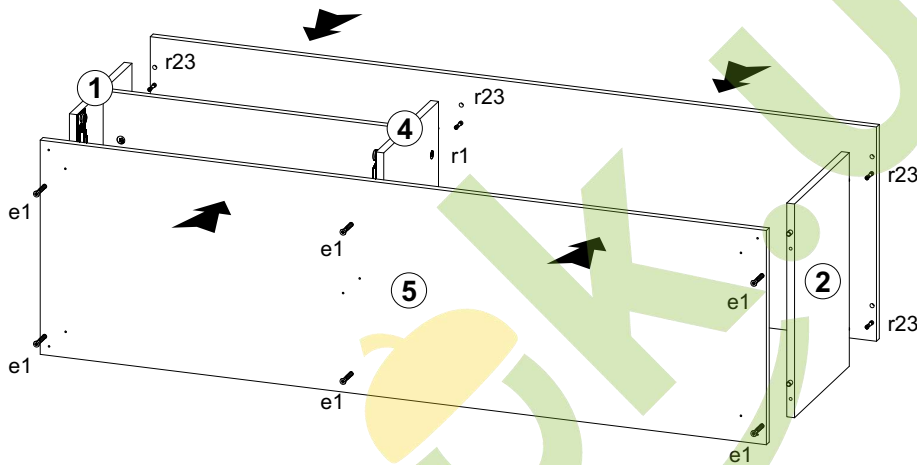
**10**

36x  l1

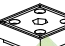
5x  k52 $56 \times 56 \times 20 \text{ mm}$

10x  $\phi 4 \times 30 \text{ mm}$ p21

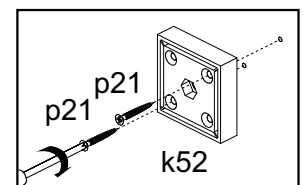
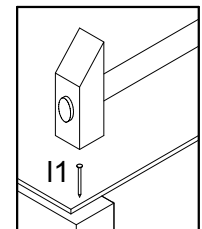
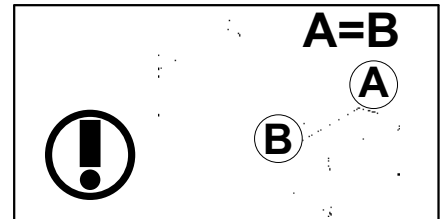
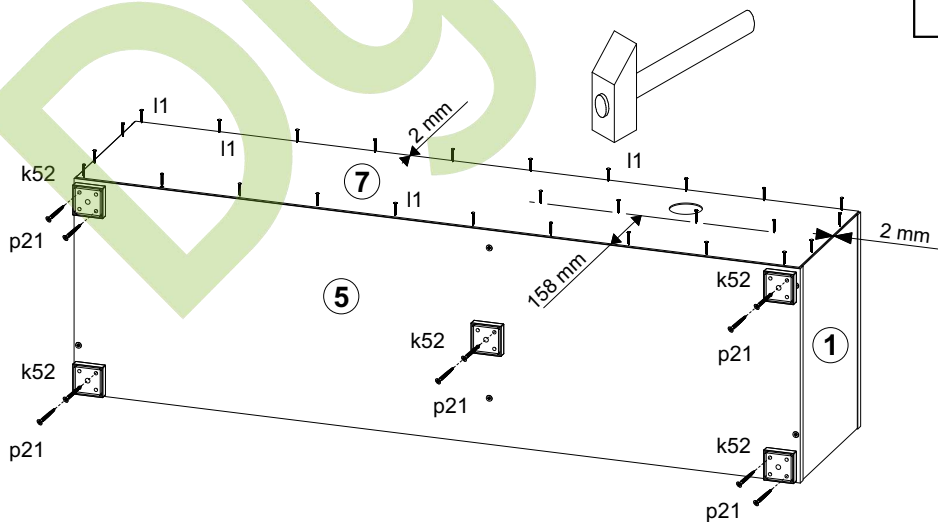

11

- 1x L 340 mm **c520**
- 4x $\phi 5 \times 50$ mm **e32**
- 3x $\phi 4 \times 30$ mm **p9**
- 4x $\phi 3 \times 12$ mm **p54**
- 4x $\phi 30 \times 11$ **r23**
- 4x $\phi 15 \times 12$ mm #16 **r1**
- 4x $\phi 16$ **s2**
- 1x 350 mm **w45^{DL}**
- 1x 350 mm **w45^{DR}**

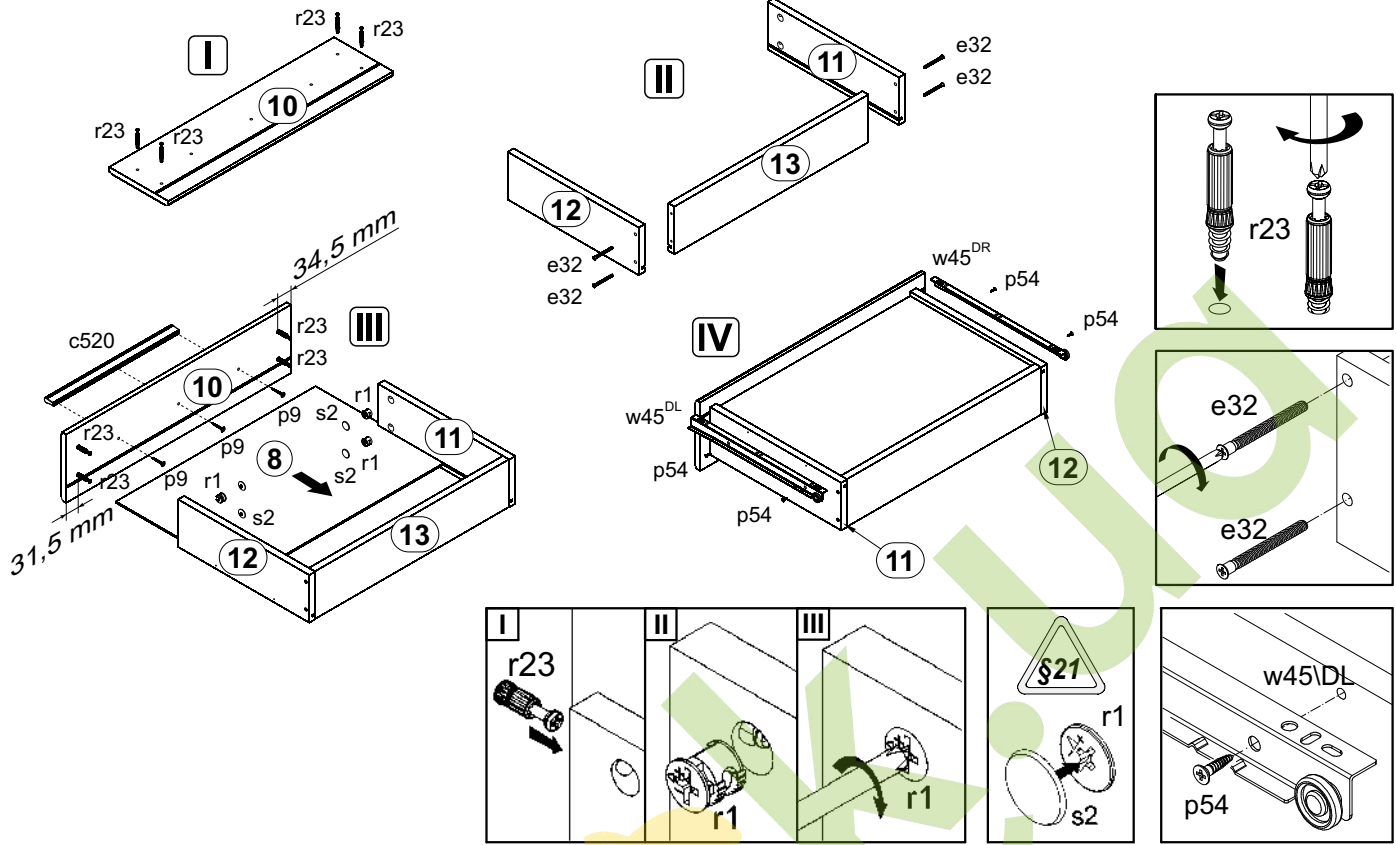

12

- 2x **b1**
- 1x L 340 mm **c520**
- 1x **m48**
- 4x $\phi 3,5 \times 13$ mm **p1**
- 3x $\phi 4 \times 30$ mm **p9**
- 6x $\phi 16$ **s2**

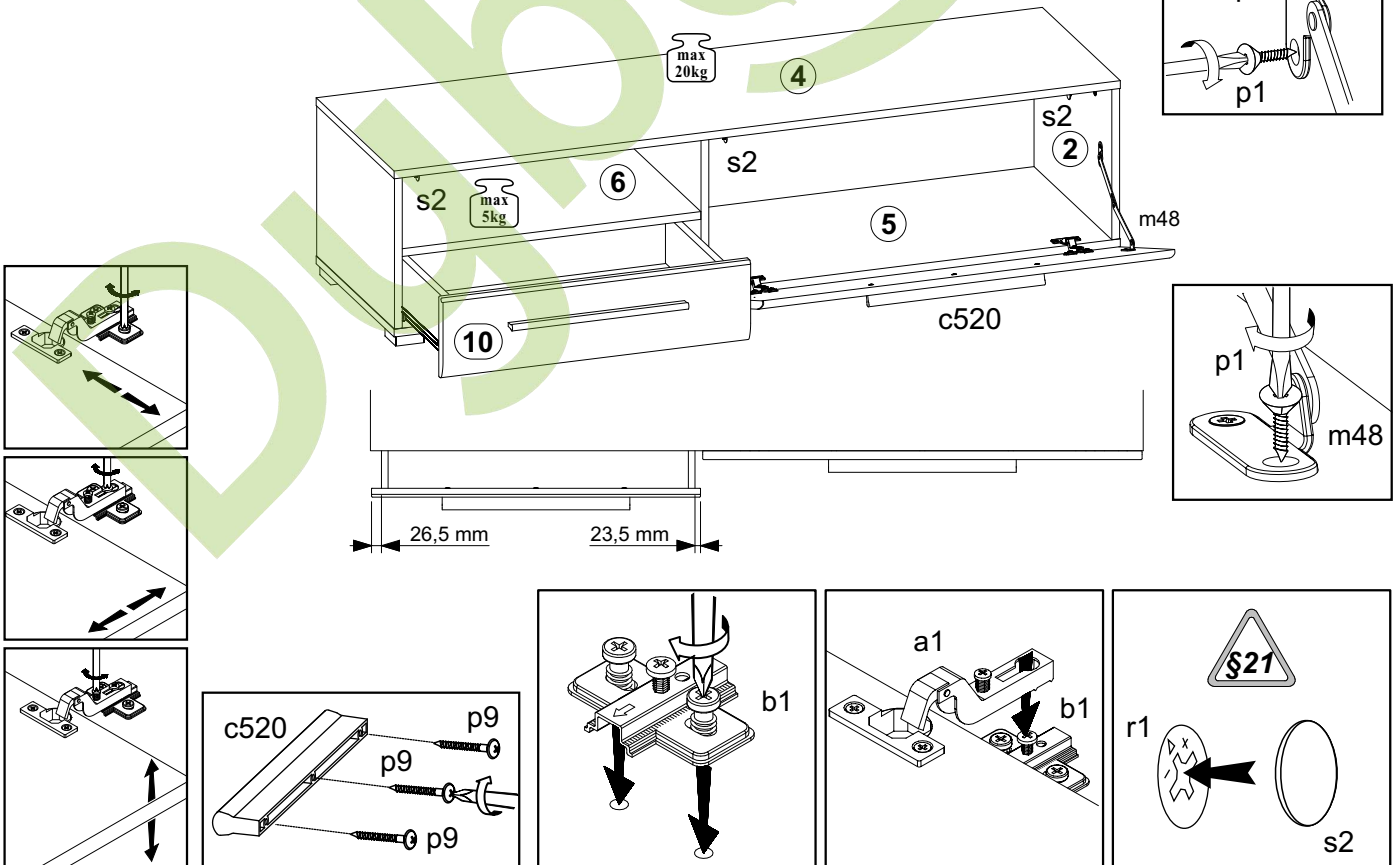



Вітрина навісна ліва / Витрина навесная левая / Witryna wisząca lewa

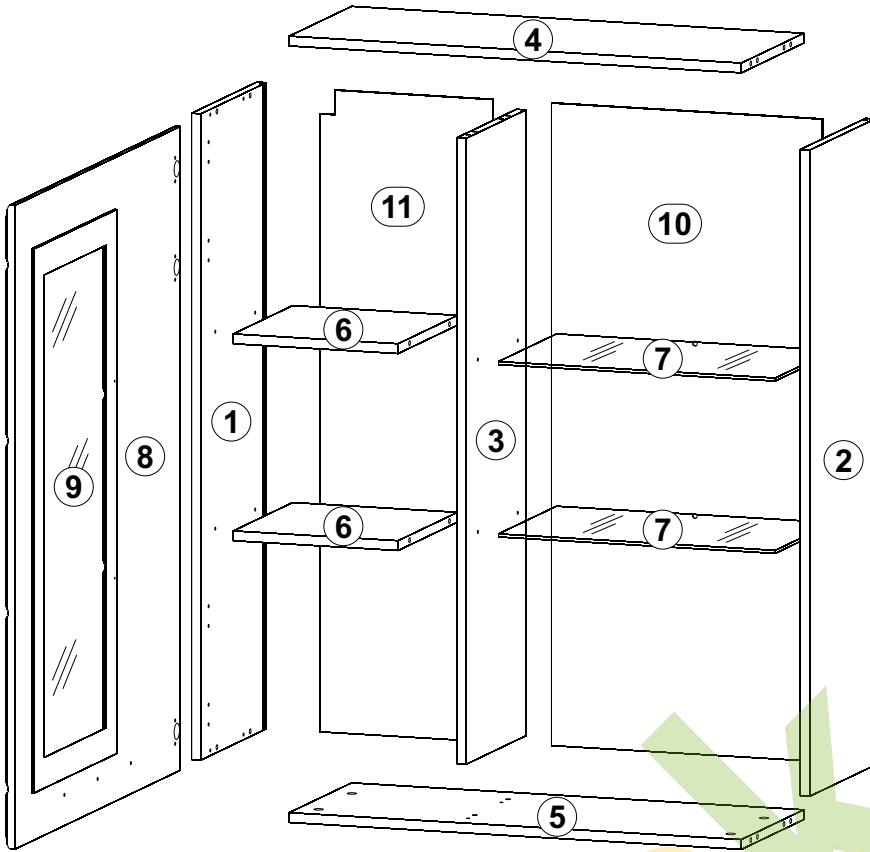

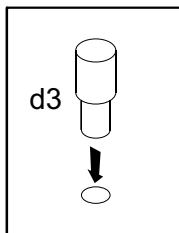
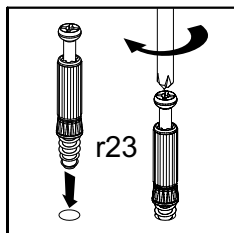
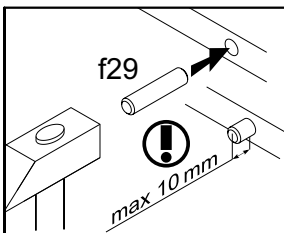
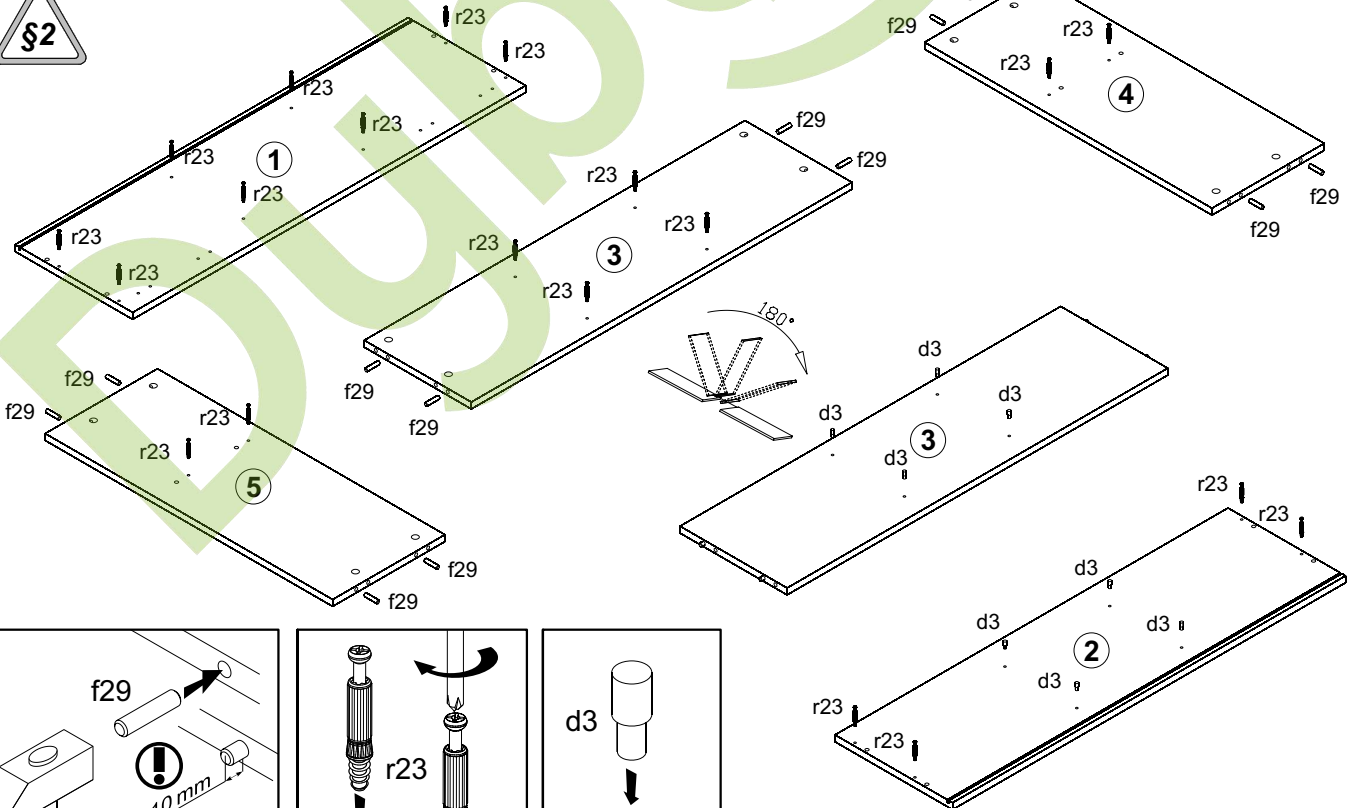
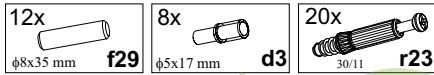

| A | B | C | D | |
|----|------------|------|-----|-----|
| 1 | PU1-107-01 | 1050 | 314 | 3/5 |
| 2 | PU1-108-01 | 1050 | 314 | 3/5 |
| 3 | PU1-109 | 1017 | 286 | 3/5 |
| 4 | PU1-303 | 768 | 300 | 3/5 |
| 5 | PU1-302 | 768 | 300 | 3/5 |
| 6 | PU1-304 | 280 | 286 | 3/5 |
| 7 | PU1-305 | 470 | 279 | 3/5 |
| 8 | PU1-002A | 1046 | 796 | 5/5 |
| 9 | PU1-501 | 884 | 398 | 5/5 |
| 10 | PU1-902 | 1044 | 485 | 5/5 |
| 11 | PU1-903 | 1044 | 293 | 5/5 |

13

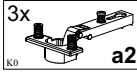
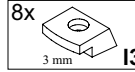
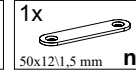

14

- 3x  a2
- 8x  l3 3 mm
- 1x  n3 50x12x1,5 mm
- 8x  p52 $\phi 3 \times 16$ mm
- 2x  p400 $\phi 3 \times 10$ mm

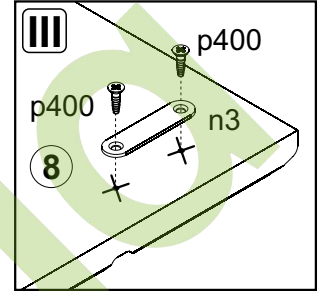
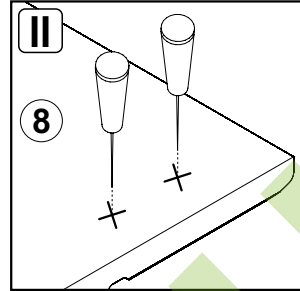
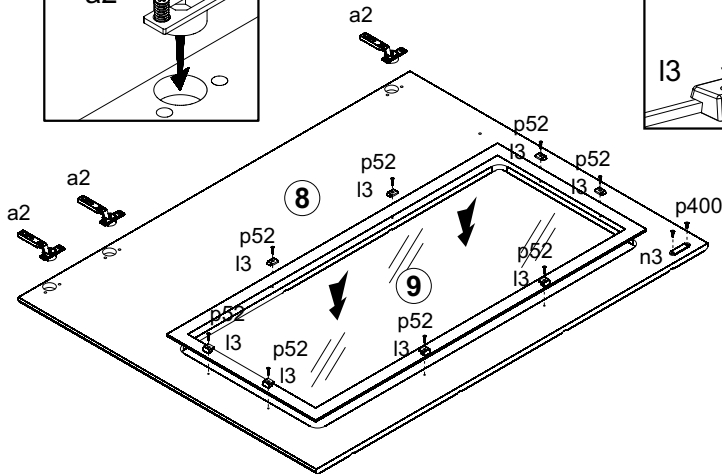
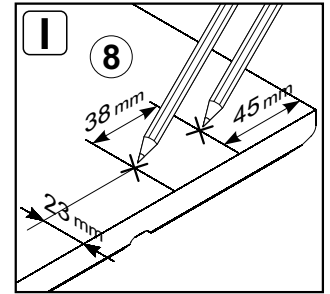
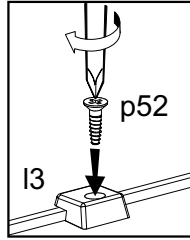
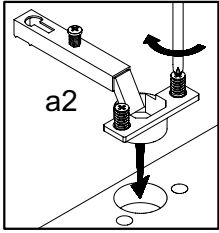

15

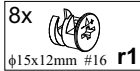
- 8x  r1 $\phi 15 \times 12$ mm #16

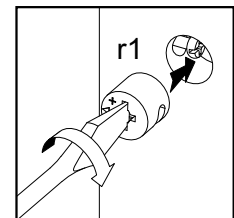
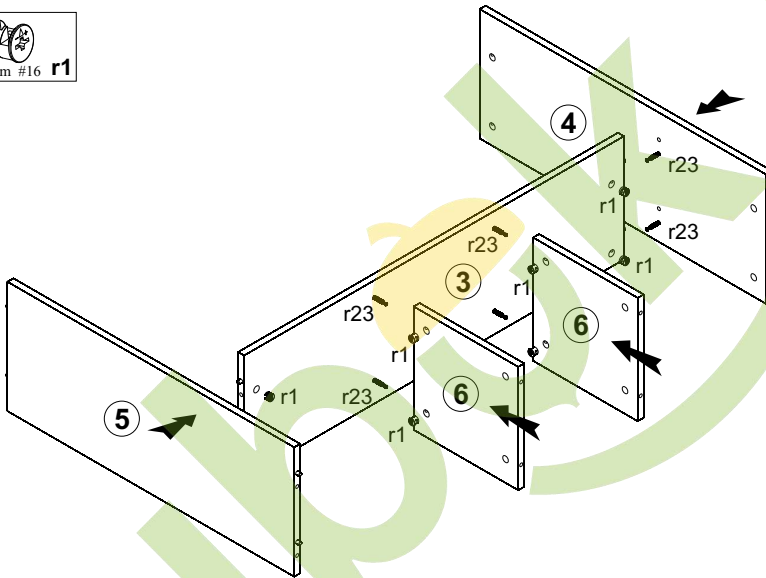

16

- 12x  r1 $\phi 15 \times 12$ mm #16

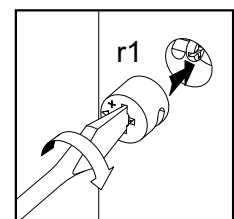
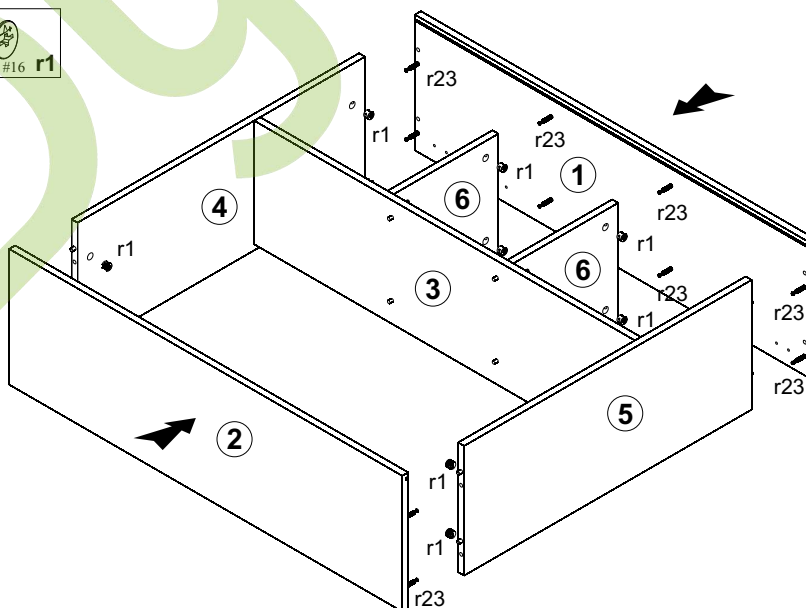

17

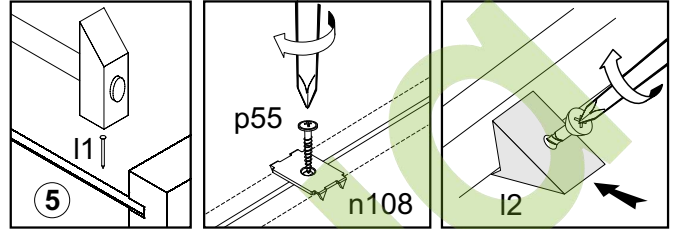
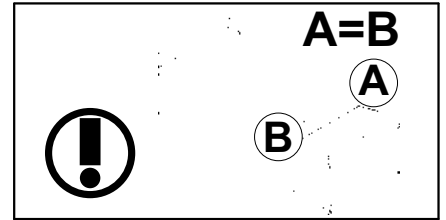
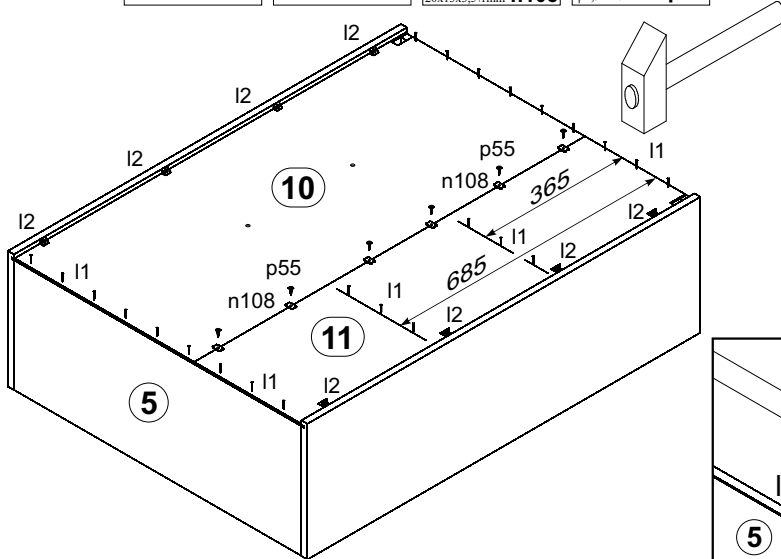
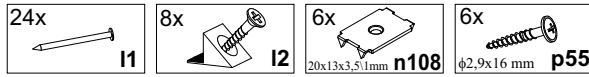

18

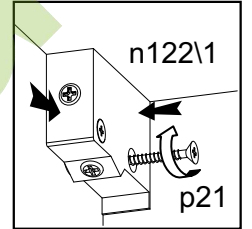
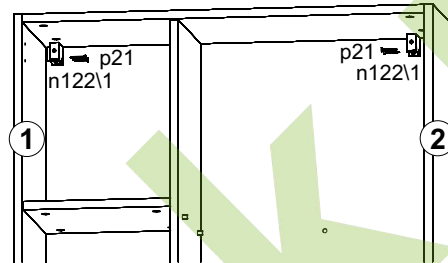
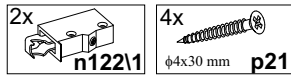

19

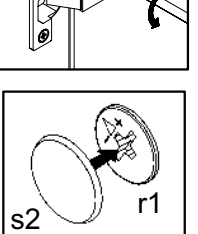
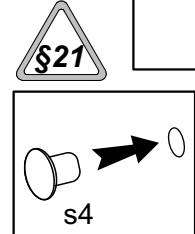
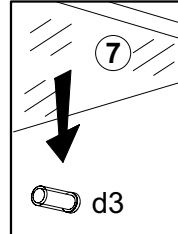
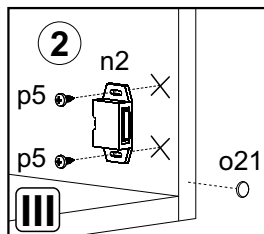
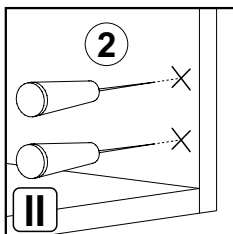
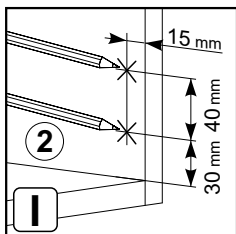
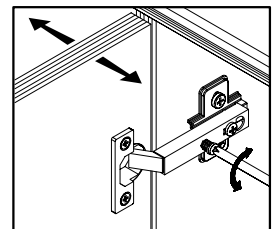
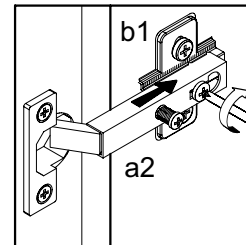
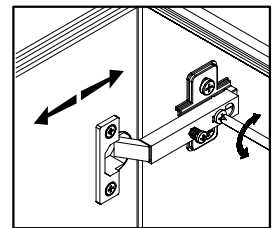
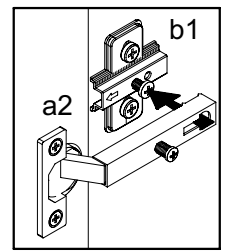
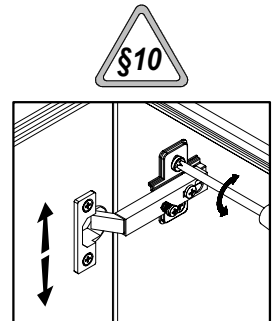
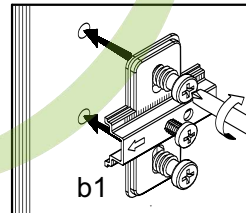
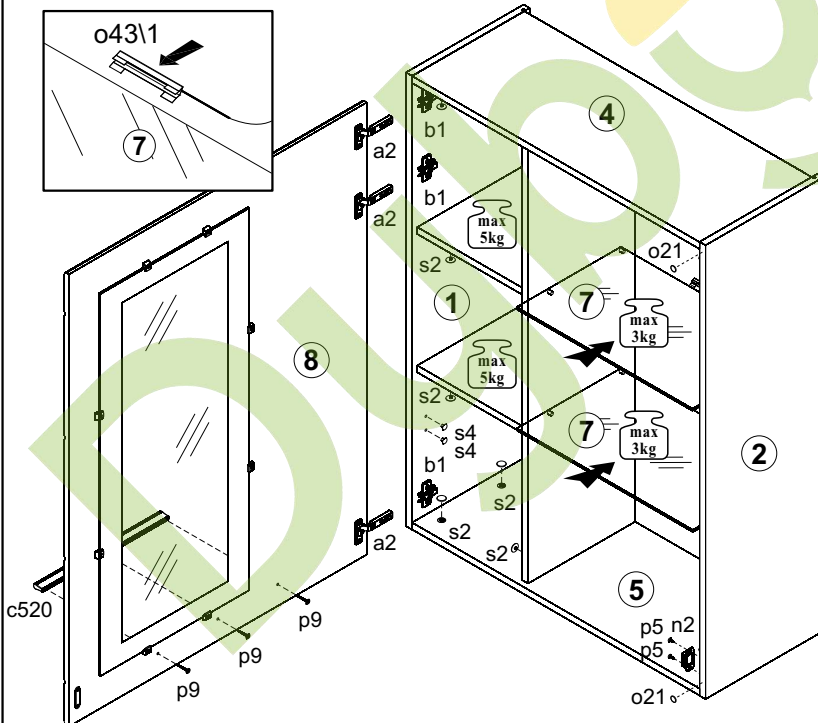

IV Вітрина навісна права / Витрина навесная правая / Witryna wisząca prawa

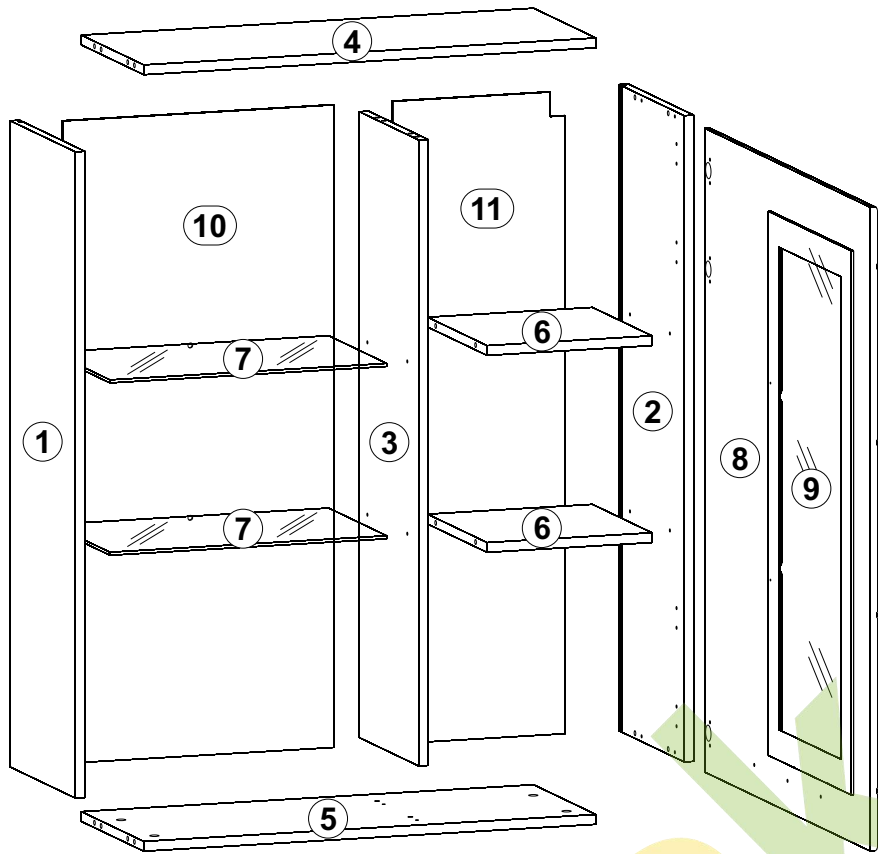

| A | B | C | D | |
|----|------------|------|-----|-----|
| 1 | PU1-108-01 | 1050 | 314 | 4/5 |
| 2 | PU1-107-01 | 1050 | 314 | 4/5 |
| 3 | PU1-109 | 1017 | 286 | 4/5 |
| 4 | PU1-302 | 768 | 300 | 4/5 |
| 5 | PU1-303 | 768 | 300 | 4/5 |
| 6 | PU1-304 | 280 | 286 | 4/5 |
| 7 | PU1-305 | 470 | 279 | 4/5 |
| 8 | PU1-007A | 1046 | 796 | 5/5 |
| 9 | PU1-501 | 884 | 398 | 5/5 |
| 10 | PU1-905 | 1044 | 485 | 5/5 |
| 11 | PU1-906 | 1044 | 293 | 5/5 |

20

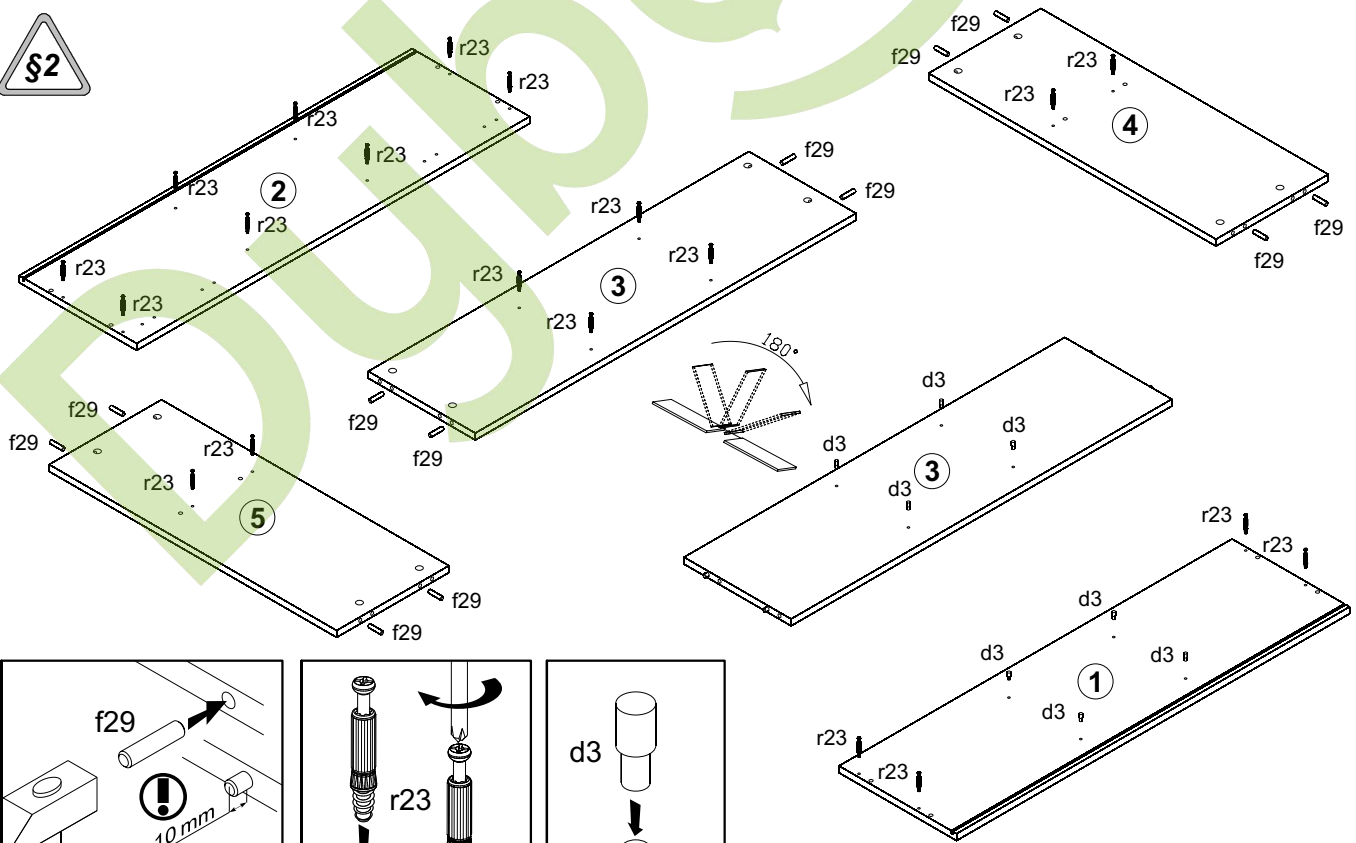
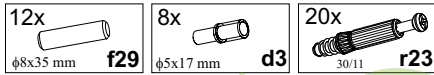

21

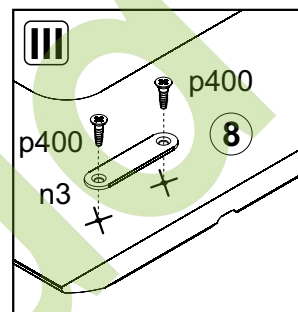
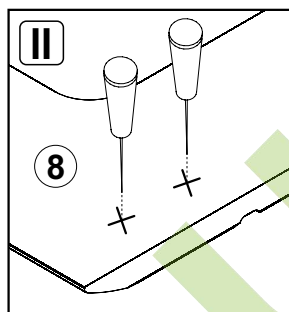
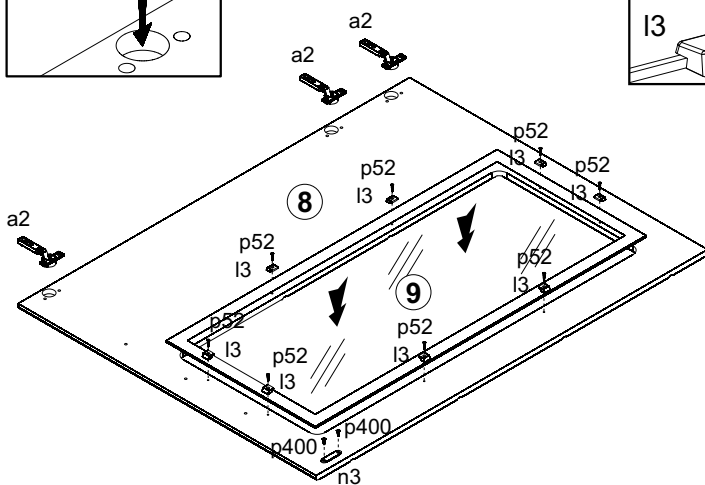
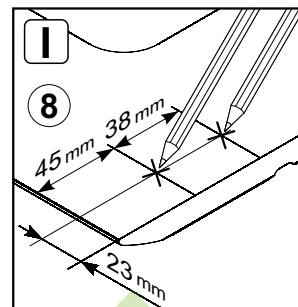
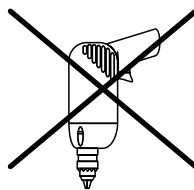
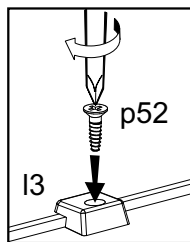
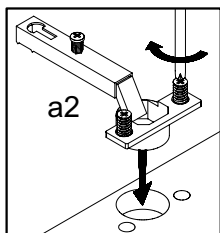
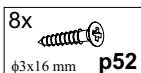
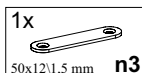
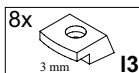
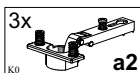

22

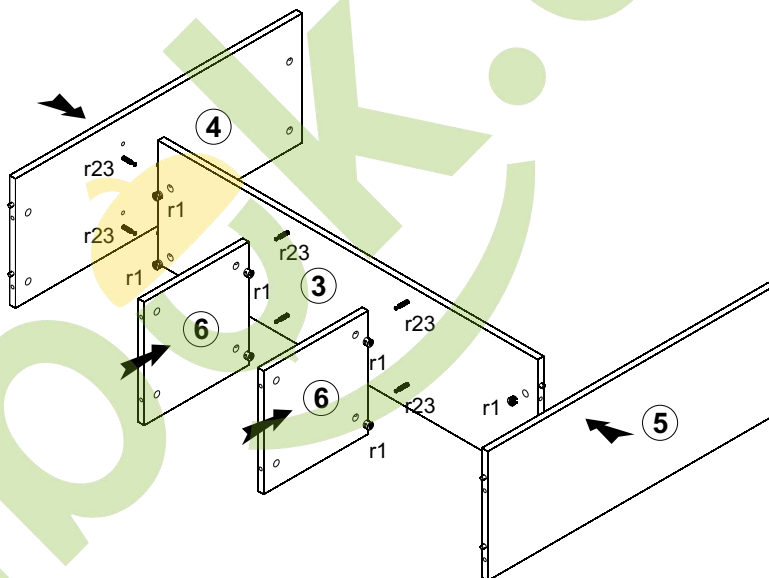
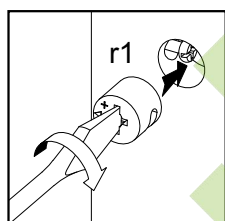

23

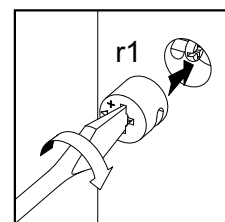
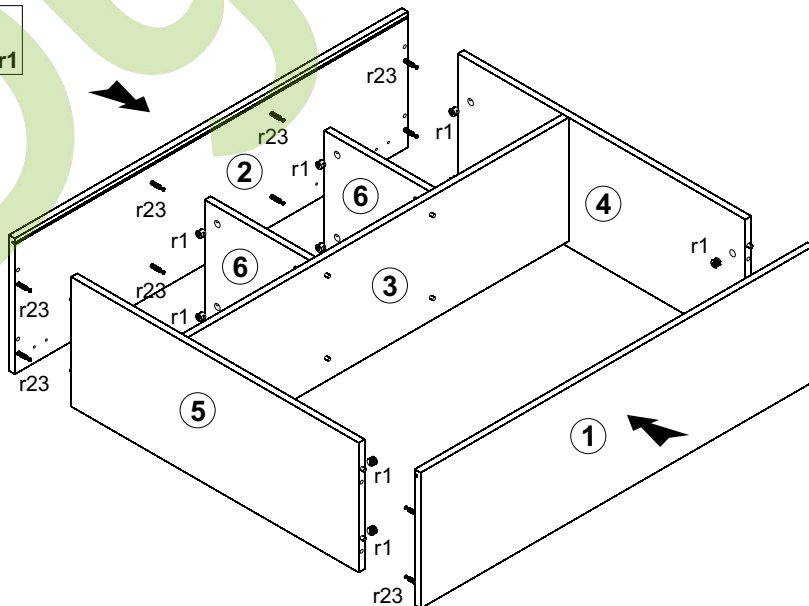

24

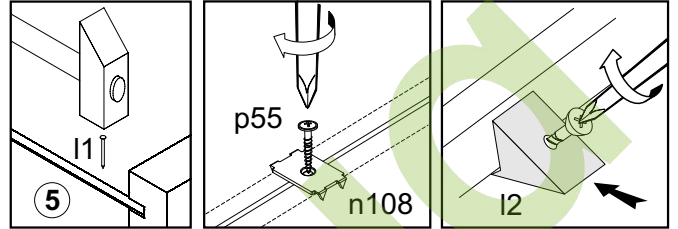
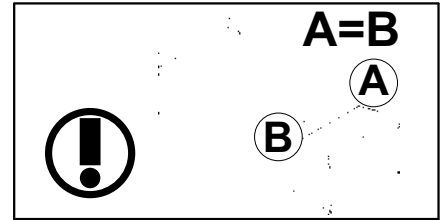
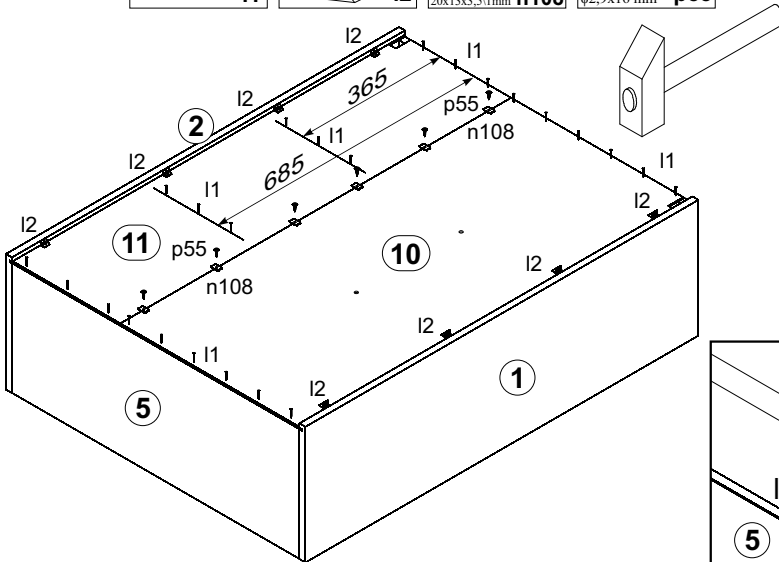
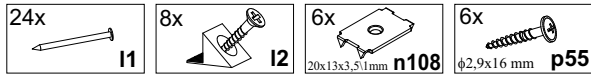

25

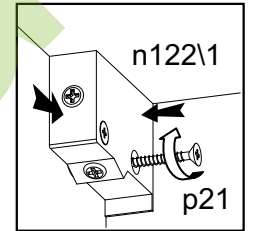
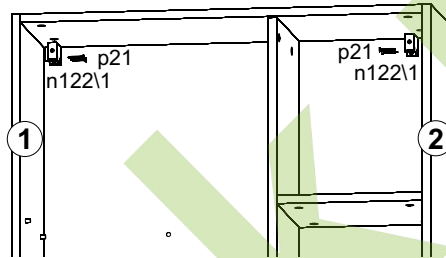
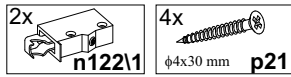

26

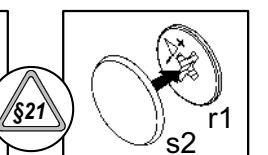
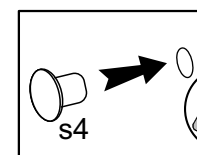
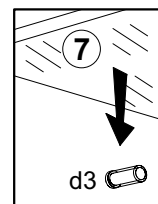
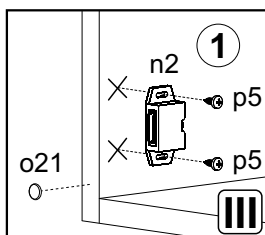
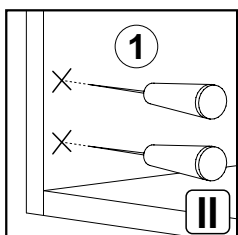
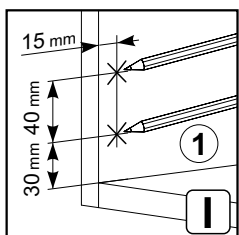
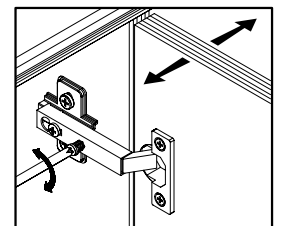
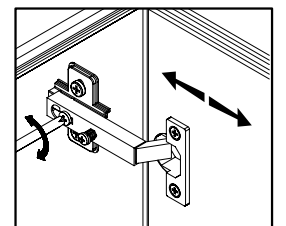
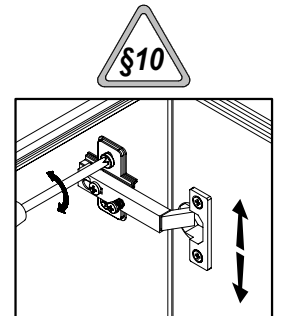
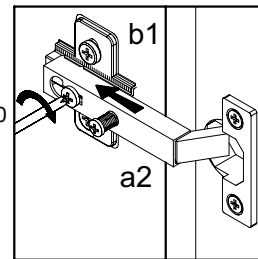
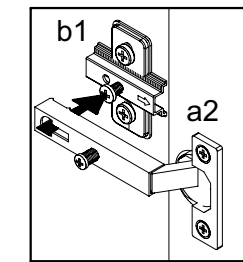
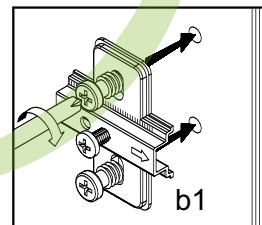
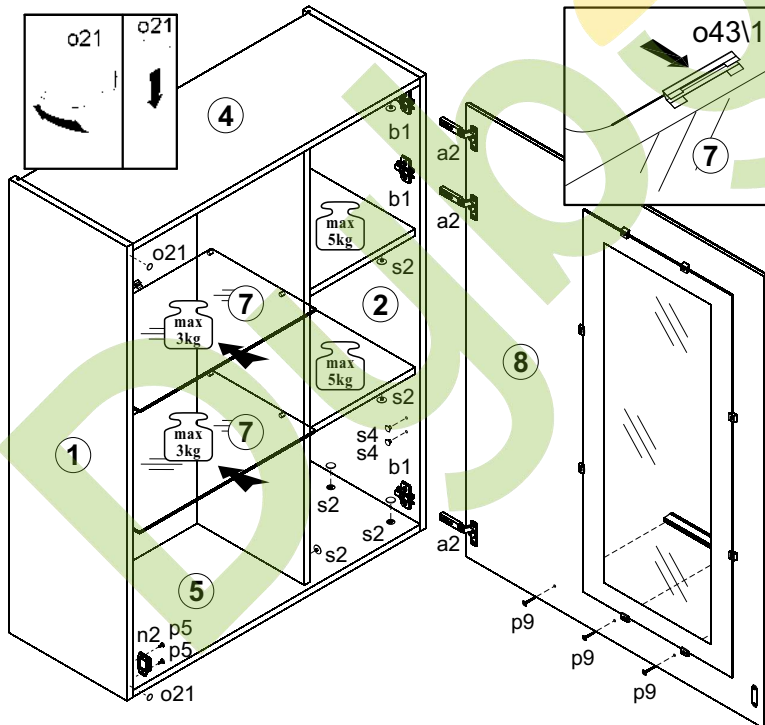
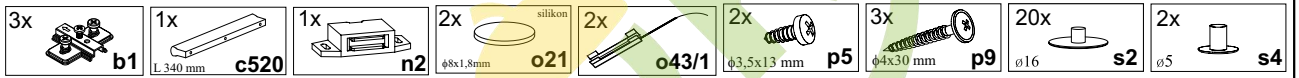

V Полиця / Полка / Półka

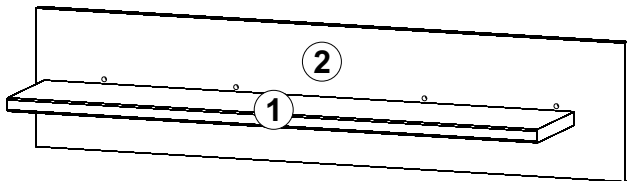

| A | B | C | D | |
|---|---------|-----|------|-----|
| 1 | PU1-306 | 900 | 180 | 5/5 |
| 2 | PU1-401 | 225 | 1000 | 5/5 |



27

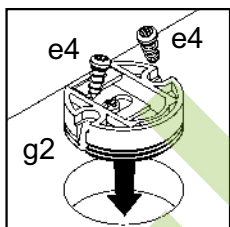
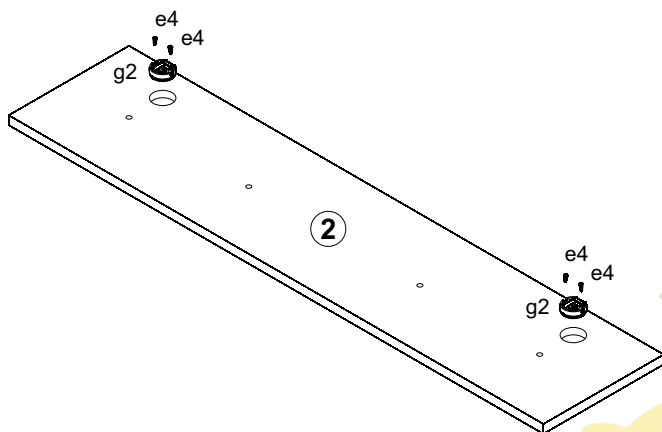
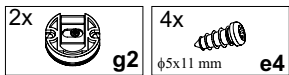

28

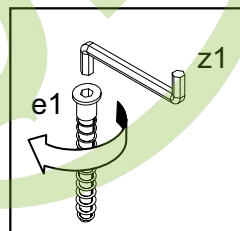
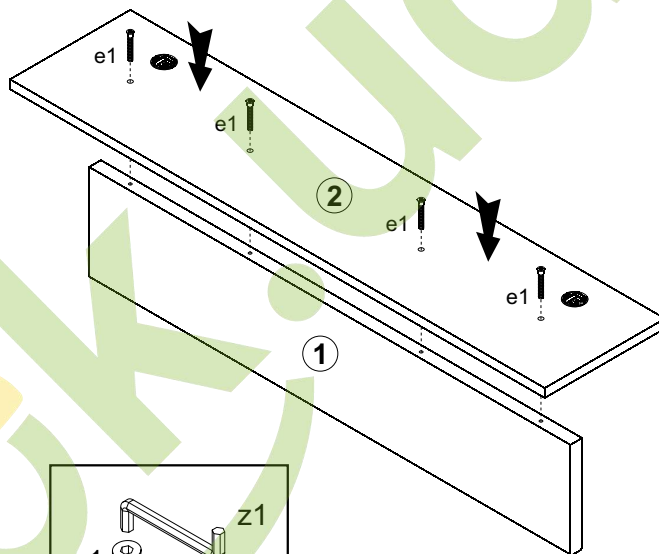
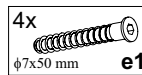

29

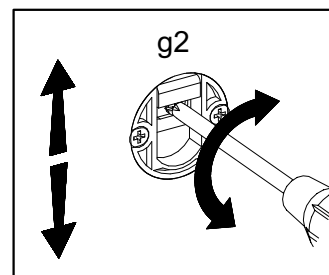
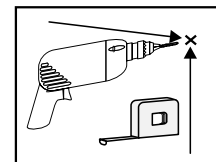
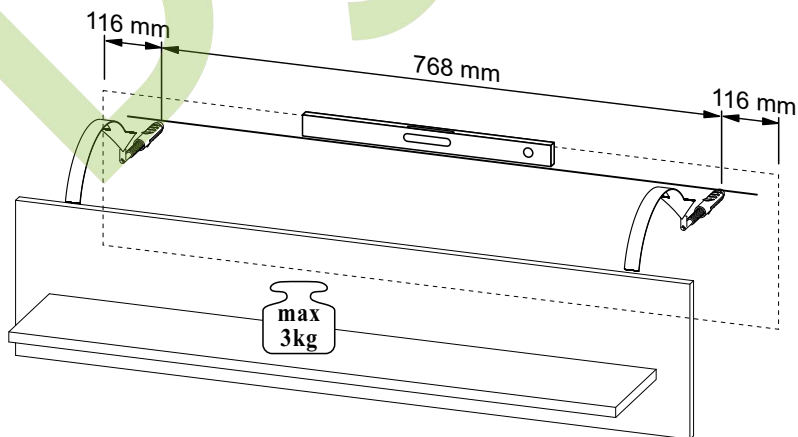
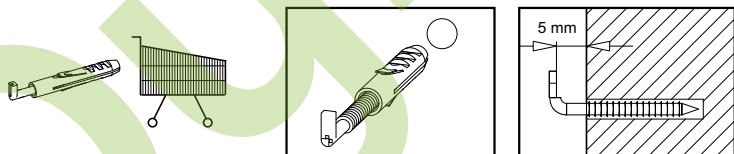

30

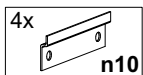

25 mm

62 mm

62 mm

25 mm

