

# АМАДЕУС

## Секція РТВ / Секция РТВ

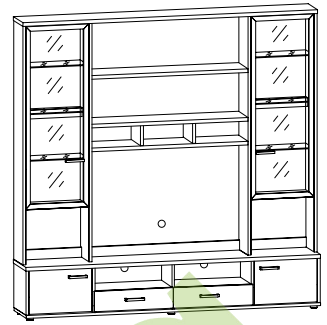

A	B	C	D
1	NS1-107	1691	340 1/8
2	NS1-106	1691	340 1/8
3	NS1-109	1691	340 1/8
4	NS1-108	1691	340 1/8
5	NS1-102	400	495 4/8
6	NS1-111	400	471 4/8
7	NS1-105	400	495 4/8
8	NS1-104	400	495 4/8
9	NS1-204	2100	503 2/8
10	NS1-205	2100	500 2/8
11	NS1-307	542	471 4/8
12	NS1-304	542	471 4/8
13	NS1-203	2100	348 2/8
14	NS1-306	1100	290 3/8
15	NS1-305	1100	290 3/8
16	NS1-110	202	285 3/8
17	NS1-303	455	311 4/8
18	NS1-401	455	80 4/8
19	NS1-403	1110	80 3/8
20	NS1-404	455	80 4/8
21	NS1-402	455	80 4/8
22	NS1-502	450	120 5/8
23	NS1-503	450	120 5/8
24	NS1-501-01	485	120 5/8
25	NS1-902	500	449 7/8
26	NS1-905	1660	486 7/8
27	NS1-906	730	1120 7/8
28	NS1-909	224	1120 7/8
29	NS1-908	706	1120 7/8
30	NS1-904	445	1120 7/8
31	NS1-907	445	486 7/8
32	NS1-505	454	308 8/8
33	NS1-002	1340	450 6/8
34	NS1-001	1340	450 6/8
35	NS1-004	450	395 5/8
36	NS1-006	545	197 5/8
37	NS1-005	545	197 5/8

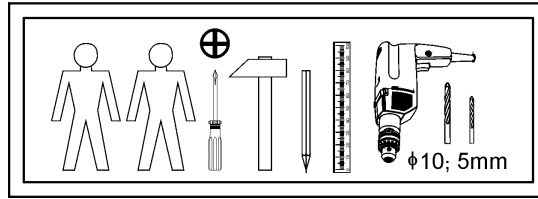
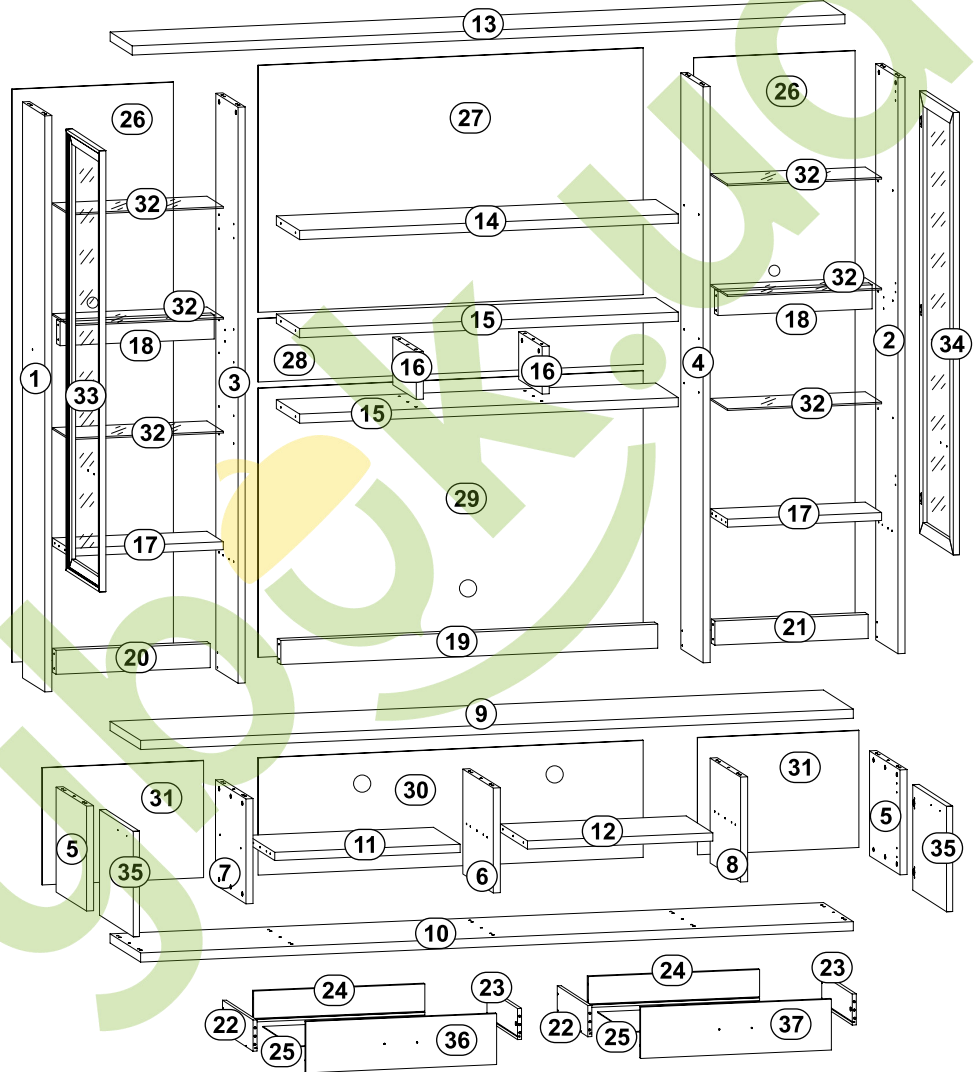

4x  a1	4x  b1	6x  a43	6x  b13	6x  c333	24x  d3 φ5x17 mm	4x  d4 Ø6x15 mm	9x  e3 φ6x13 mm
12x  e5 Ø6,3x13 mm	22x  e8 φ7x60 mm	8x  e32 φ5x50 mm	66x  f1 Ø8x30 mm	8x  j1 M4x20 mm	4x  j3 M4x11 mm	6x  k27	225x  l1
4x  n52 62x12/1mm	4x  o1	2x  o4	4x  o26 Ø4,5/Ø8x0,5 mm	23x  p1 Ø3,5x13mm	12x  p7 φ3,5x20 mm	4x  p20 Ø3,5x20mm	8x  p54 φ3x13 mm
24x  r1 Ø 15 # 15	40x  r3 Ø 15 # 22	2x  r10	60x  r16	20x  s1	2x  w24 <sup>CL</sup> 450 mm	2x  w24 <sup>CR</sup> 450 mm	2x  w24 <sup>DL</sup> 450 mm
2x  w24 <sup>DR</sup> 450 mm	1x  n26/1	1x  p38 Ø3,5x16 mm	40x  s2 Ø 16	1x  z1			

# 1

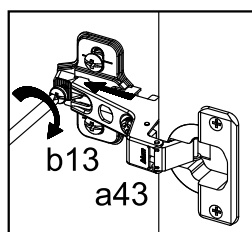
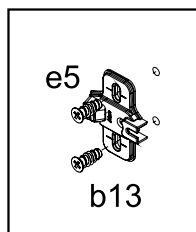
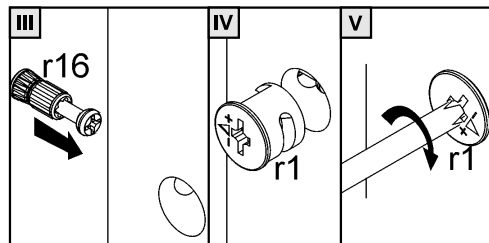
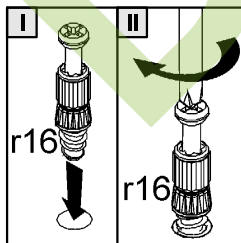
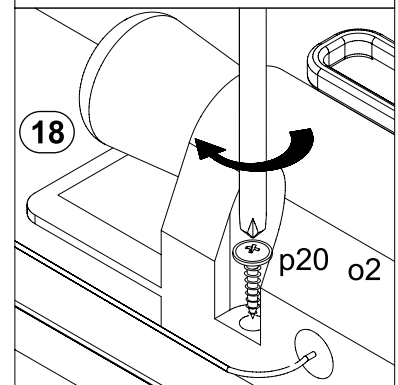
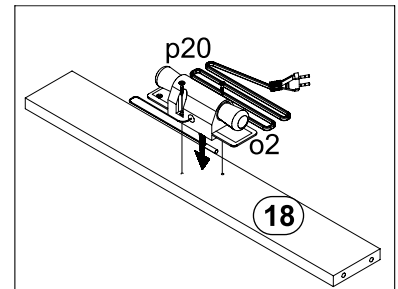
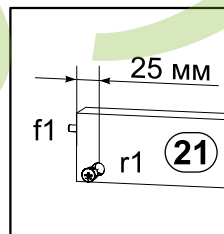
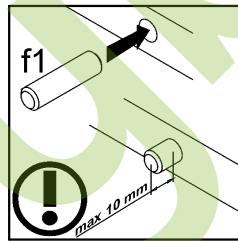
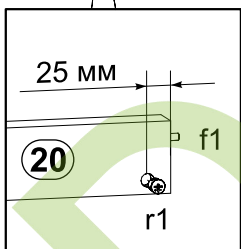
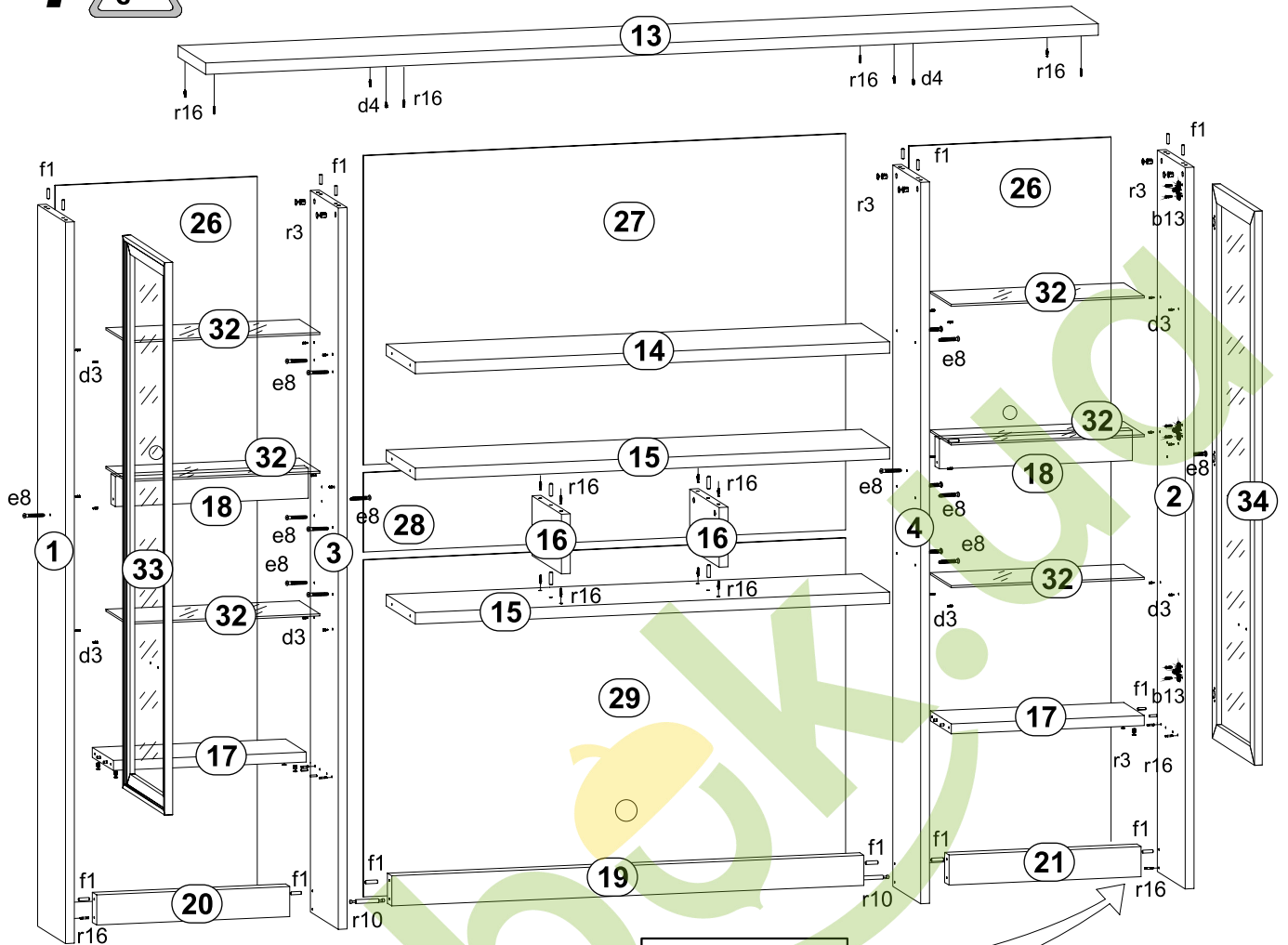

# 2

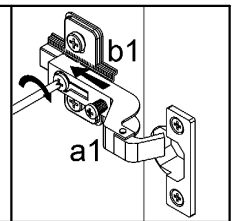
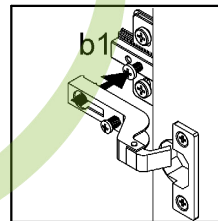
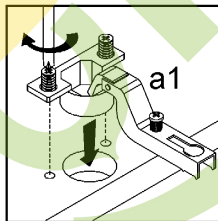
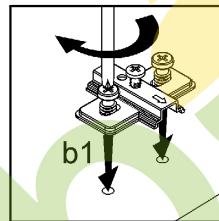
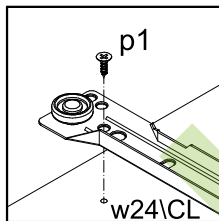
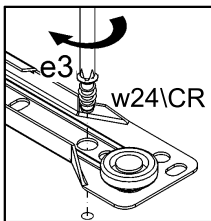
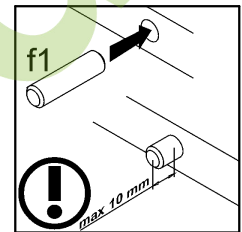
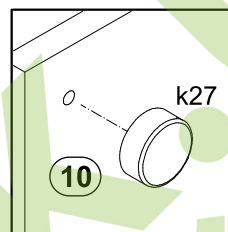
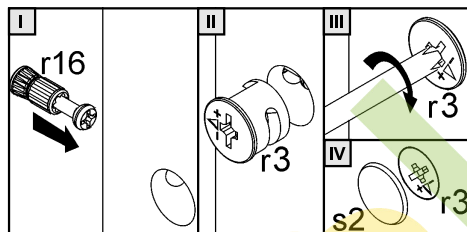
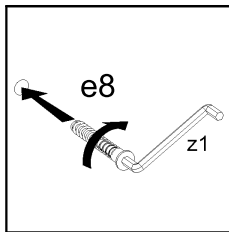
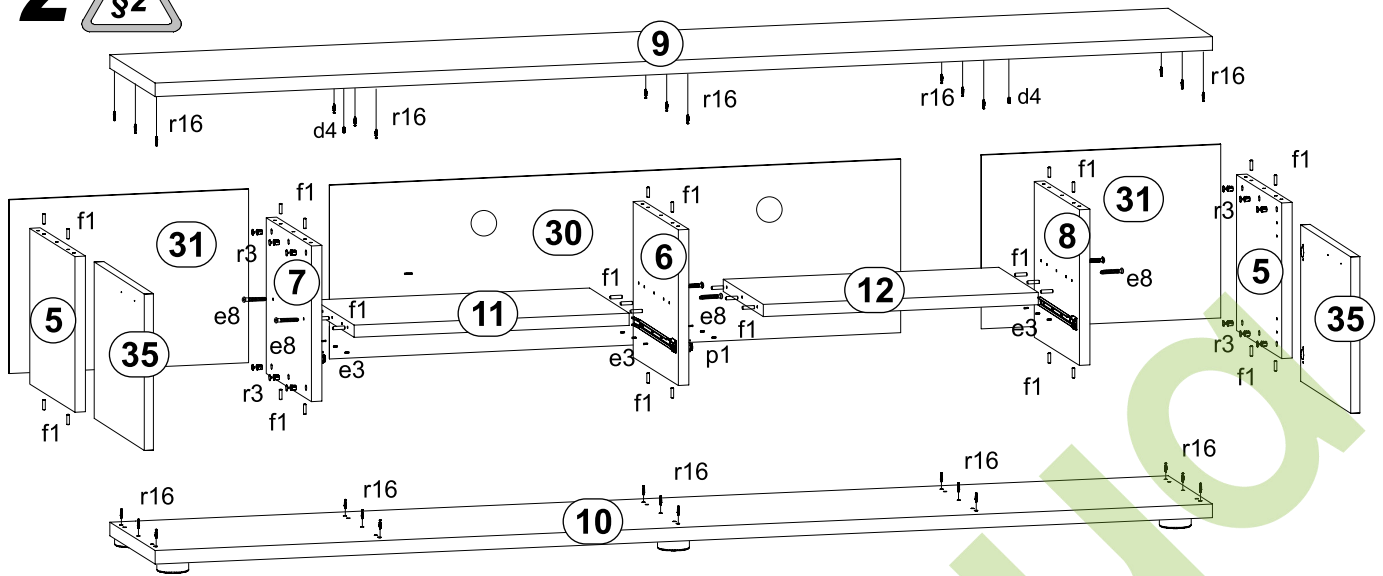

# 3

I

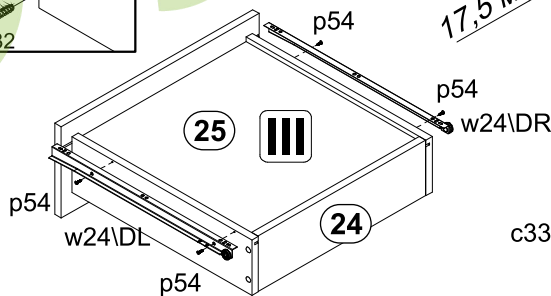
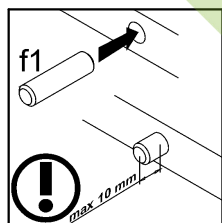
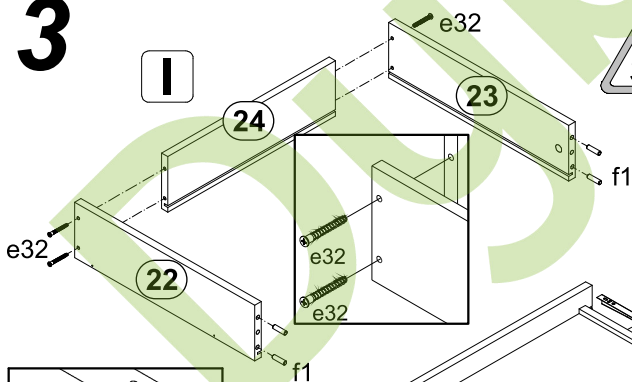

II

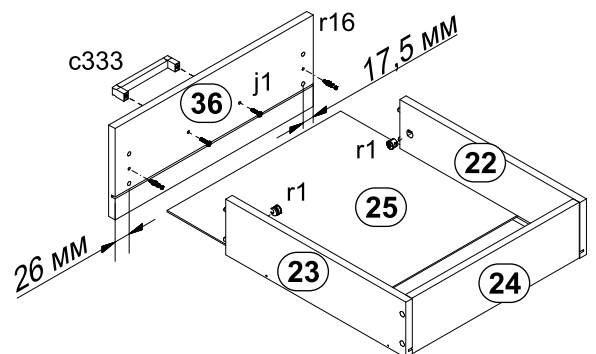
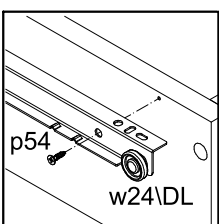
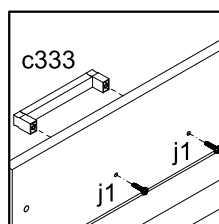
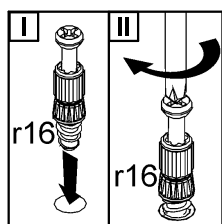
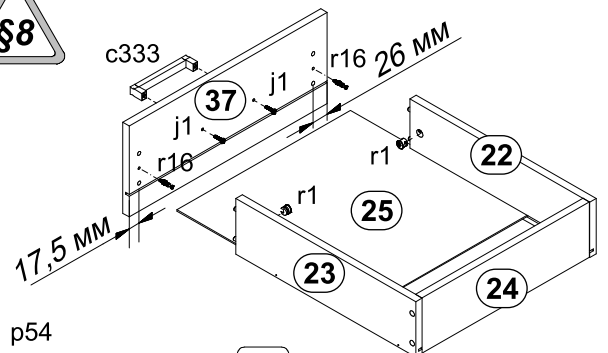

# 4

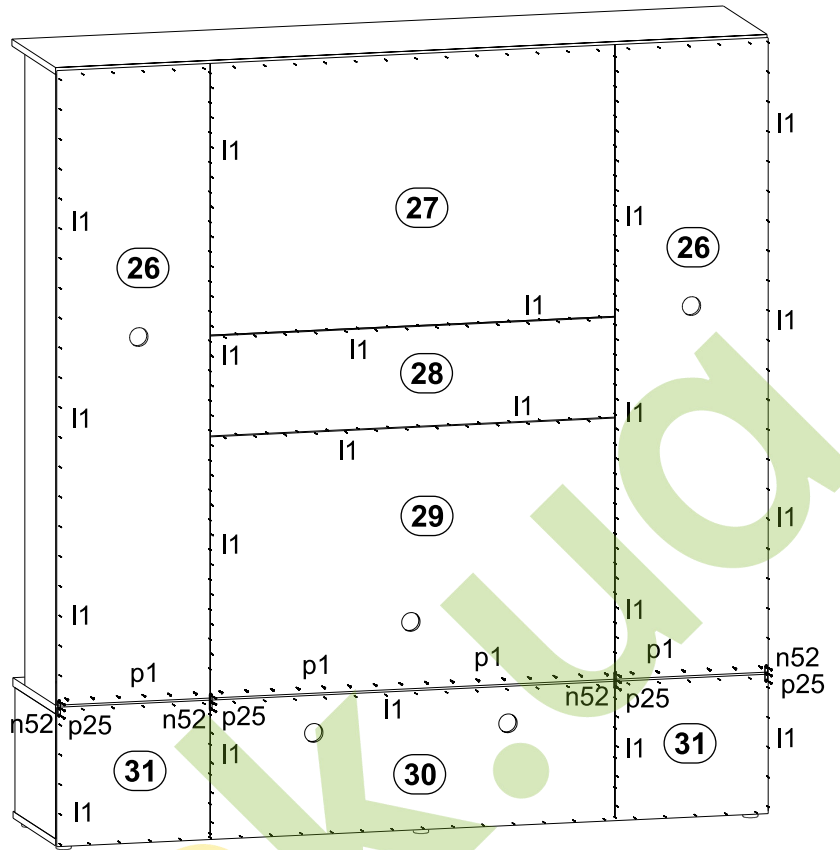
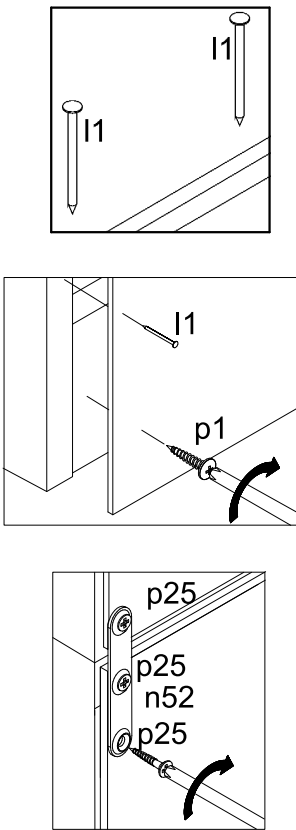

# 5

**УВАГА!**  
 При монтажі ручок вітрини  
**ОБОВ'ЯЗКОВО**  
 ЗАСТОСУВАТИ ПРОКЛАДКИ **o26** і **o1**!

**ВНИМАНИЕ!**  
 При монтаже ручек витрины  
**ОБЯЗАТЕЛЬНО**  
 ПРИМЕНЕНИЕ ПРОКЛАДОК **o26** и **o1**!

